

ALL LIGHT Series

USER MANUAL

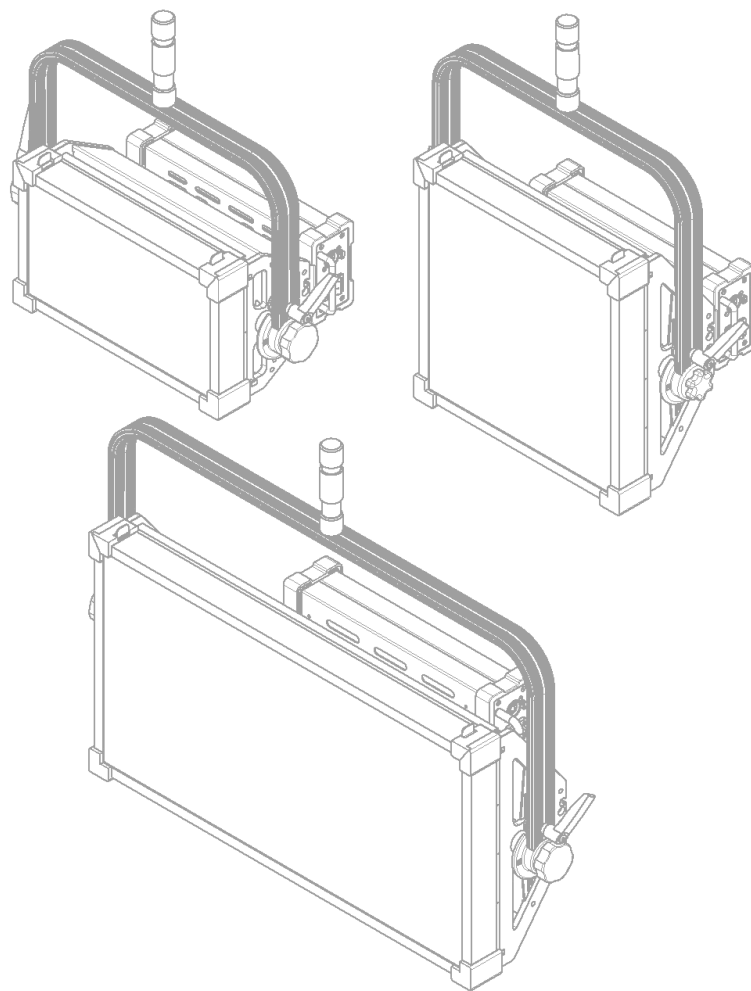

Matrix Light

••• Contents •••

About the product

| | |
|--------------------------------------|---|
| 01. Special features | 1 |
| 02. Important notices | 2 |
| 03. Safety and handling | 3 |
| 04. Product package components | 7 |

Name and function of each part

| | |
|----------------------|---|
| 01. LED Lights | 9 |
|----------------------|---|

Installation and Use of Light

| | |
|---|----|
| 01. How to Install and Use Light | 11 |
| 02. How to operate the touchscreen | 15 |
| 03. DMX Menu Configuration | 26 |
| 04. Bluetooth Connection and App. Operation | 31 |

Troubleshooting

| | |
|--|----|
| 01. Self-troubleshooting checklist | 32 |
|--|----|

Additional information

| | |
|---------------------------------------|----|
| 01. Warranty information | 33 |
| 02. Storage guidelines | 33 |
| 03. Product specifications | 33 |
| 04. Servicing and repairs guide | 36 |

- For your safety, please read the "Safety and Handling" instructions carefully before using the ALL LIGHT products.
- ALL LIGHT products may be subject to technical improvements without prior notice from Matrix Light.
- Refer to this user manual for installation and safe use of the product.
- This manual can be downloaded free of charge from the Matrix Light website at www.matrixlight.com

••• About the Product

01. Special features •••

Matrix light ALL LIGHT

Thank you for choosing the Matrix Light All Light Series. All Light 1, 2, and 4 have been designed and built with the goal of creating the ultimate lighting that professionals have wanted. The product reflects the diverse needs of the field and creates a fast and seamless user experience that enables professional users to deploy light sources as closely as possible in the real world. Professional users can easily meet their needs by using the All Light Series when they need multi-functional, high-performance lighting to suit their situations, such as broadcasting, movies, commercials, and live events.

Graphic touch interface

The Matrix Light All Light Series features an innovative Graphic Touch control interface, which provides users with quick and easy access to a variety of menus, making it incredibly easy and convenient to control compared to the complex and cumbersome operating methods adopted by similar products.

Wire / wireless control interface

The Matrix Light All Light Series complies with the DMX-512 standard protocol to make it fully compatible with traditional lighting controllers. The All Light Series can also be controlled with smartphones and tablets via Bluetooth connection.

Preset / Preset Save

The Matrix Light All Light Series has a preset menu that recreates the colors of many different light sources. In addition, the colors and brightness of the various light sources you set are saved through the Preset Save menu, and the saved settings can be recalled and used at any time. These features make it very convenient to match the settings of the same lighting when shooting multiple scenes in succession on the scene.

Multi effect and color filter

The ALL LIGHT provides users a wide range of preset lighting effects. Users can also easily create their custom lighting effects by using the ALL LIGHT effect creator. The ALL LIGHT includes hundreds of color filters, which can be accessed by their code value or name. The color filters not only simplify the color lighting process, but also enable precise and flexible color control.

Stronger body, better performance

The ALL LIGHT's main body includes a high-efficiency aluminium heat sink and a cooling fan. This feature help minimize the effect of temperature difference on the ALL LIGHT's performance. In addition, the mechanical strength and lifespan of the product's key parts and accessories have been significantly improved. All Light will be the most ultimate form of LED light, providing the highest quality of light as intended by the photographer.



* Visit www.matrixlight.com for a downloadable version of this product manual.

••• About the Product

02. Important notices •••

For your safety, please carefully read and understand the following before continuing:

Safety symbols

| Icon | Classification | Definition |
|---|----------------|---|
|  | DANGER | Death or serious injury will follow if warning is not heeded. |
|  | CAUTION | Injury or product damage loss will follow if warning is not heeded. |

Safety-related matters of the product and the warranty service

Be sure to familiarize yourself with safety precautions before using this product.

- Illustrations in the manual are for description purposes only; actual products may vary.
- Before requesting service, refer to the 'Check before reporting any faults' section to check if the product is defective.
- In the event of a non-failure, the service must be requested at a certain cost, even within the warranty period.
- The user is solely responsible for any injury or product damage caused by failure to follow the instructions.
- Make sure to check that the product is functioning normally before filming.

Copyright

©2019 Matrix Light

All rights reserved. No part of this manual shall be reproduced, stored in a retrieval system, or transmitted by any means, electronic, mechanical, photocopying, recording, or otherwise, without written permission from Matrix Light.

••• About the Product

03. Safety and handling •••

For your safety, please carefully read and understand the following before continuing:

High voltage! Risk of electric shock and fire.

- ⚠ Read and understand all safety information and operating instructions before installing and operating the product.
- Ⓢ Failure to comply with safety information or general rules may result in injury, death, or damage to equipment to oneself and others.
- ⚠ Always verify that the local AC power source matches the voltage and frequency range printed on the product type label before using.
- ⚠ Use only genuine Power Supply Unit (PSU) and dedicated connection cables designed for Matrix Light All Light.
- Ⓢ To protect against electric shock, always connect the external power supply to ground (ground) electrically when connected to AC power. The AC mains power supply must be equipped with a fuse or circuit breaker and a ground fault (ground failure) protection.
- Ⓢ Only use a power supply dedicated to the Matrix Light All Light and a connector cable dedicated to the Matrix Light. Using other power supplies and connector cables can cause malfunction and damage to the product.
- ⚠ When using a battery pack, always ensure that the voltage matches the voltage range printed on the product type label before connecting the battery pack to the product.
- ⚠ Never use the power cables for transportation. Never hang heavy objects on the power cables. Do not hang the battery pack on the product connection cable.
- ⚠ Do not disassemble or open the product on your own.
- Ⓢ Never repair any part of the product on your own. Maintenance and repair work is only carried out in the Matrix Light Service Center, and if repaired on your own, the product is not eligible for after-service assurance.
- Ⓢ Do not bypass or remove the safety features of the product.

Humidity and Condensation, Electric shock and fire hazard

- ⚠ Do not expose the product to rain or moisture. Do not use the product for 2 hours when exposed to a large temperature difference as condensed moisture may electrically damage the product when switched on.
- ⚠ Do not bend the power cable directly after the connector. Moisture could enter the connection and cause damage to the product.

Overheating, fire hazard

- ⚠ Do not operate the product if the ambient temperature exceeds 45°C.
- ⚠ Intensive use of the product may result in hot surfaces (up to 80°C). Make sure that the product is sufficiently cooled before handling the product.
- ⚠ Do not cover air vents when operating the product. Keep a clearance around the vents of at least 0.5m(1.65ft).
- ⚠ Do not place the product near heat sources. Intense heat may damage the product and / or cause automatic power offs.

Intense light! Risk of injury and fire.

- ⚠ Do not stare directly at the light source. Risk of irreversible eye damage. Wear safety glasses when this is unavoidable. Keep a minimum distance of 1.0m(3.3ft) from illuminated surfaces, objects, and people when operating.
- ⚠ Never use the product without a dedicated diffuser installed.
- ⚠ Always wear safety glasses when the product is connected to an AC power supply or a battery pack. Keep a minimum distance of one meter from the LED panel. The product may cause eye injury when it is suddenly turned on.
- ⚠ Always connect the product directly to AC power. Do not connect the product to a dimmer system. It may damage the product.

Heavy weight! Risk of injury.

- ⚠ The equipment and accessories must be secured so that they do not fall when mounted on the floor level. In particular, if the product is fastened to the ceiling, in addition to clamping the combined studs, be sure to install and construct the product so that it does not fall off the ceiling even if the product is pulled out of the clamp using an auxiliary safety cable that can withstand more than 10 times the product load.
- ⚠ Attach an approved safety cable to prepare for clamp or bracket failure when mounting the product on the floor. The safety cable must be able to withstand at least 10 times the weight of the product, including all accessories mounted on the product. The safety cables shall comply with EN 60598-2-17 Section 17.6.6 and shall be products approved by a formal instrument such as TUV.
- ⚠ Cover and install the safety cable on the "E" shaped light stand (etc.) and keep it as short as possible. Handles and floor stands should not be used as anchors for safety elements.
- ⚠ Always observe general and local safety regulations.
- ⚠ Make sure that the stirrup hangs or stands vertically. Installing the stirrup horizontally may cause the spigot and stirrup to deform or break. The supporting structure has to withstand the weight of all devices and accessories installed on it.
- ⚠ All Light 4 can damage vibration and objects or injure people when falling onto the safety cable due to its horizontal length (600mm). To reduce this occurrence, it is recommended that two safety cables be used on both sides of the fixture.
- ⚠ Whenever you install, service, or move a product or accessory, block access below the workspace and work on a stable platform.
- ⚠ If you are using accessories and third-party accessories (e.g. battery pack and battery charger), please follow the instructions in your product. They contain important safety and security information.
- ⚠ Matrix Light recommends that all electrical components, in addition to regular visual checks, be performed by experts every 12 months.
- ⚠ LED light sources in All Lights cannot be replaced individually. If the light source has reached the end of its operational life, the entire LED board must be replaced.
- ⚠ If the light source malfunctions before the specified operating life is over, contact the head office or branch office of the Matrix Light, your distributor, service agent, or similar qualified persons.

Firmware downgrade

- ⚠ After updating to version 1.0.0 or later, the firmware cannot be downgraded to a version lower than 1.0.0.

Maintenance of products

- ⚠ Do not clean the surface of the product with solvents or strong detergents.
- ⚠ Wipe the surface with a soft cloth moistened with a mild detergent. Do not rub with force.
- ⚠ Clean electrical contacts with a cotton swab soaked in isopropyl alcohol. Keep electrical contacts clean at all times and use corroded parts after replacement.
- ⚠ This product is intended to illuminate people and objects in a dry environment. Always follow safety information. Use other than those described above is not permitted and failure to comply may result in associated hazards such as product damage, short circuits, fires, electric shock.
- ⚠ Do not closely illuminate the All Light, the diffuser installed in front of the product, and the LCD display on the back of the product with high-power rays that generate hot heat over a short distance. The diffuser can be deformed by hot heat, the LCD display and internal circuits can be damaged by high brightness and heat radiation in a very short time.

Battery / Charger Related

- ⚠ Do not randomly disassemble, replace, mix, charge or short circuit the battery. Doing so may cause fire and / or explosion.
- ⚠ Charge the battery immediately when the low battery warning lamp turns on. Excessive discharging and recharging will shorten the lifespan of the battery and may damage other devices.
- ⚠ Do not expose the battery to excessive shock. May cause equipment failure, fire and explosion.
- ⚠ Do not leave the battery in a hot, humid place. May cause equipment failure, fire and explosion.
- ⚠ Only use the dedicated power line provided with the battery when charging the battery and connecting the light. Using of other power lines may cause a malfunction, fire, or explosion.
- ⚠ If the battery is charged with strange noises, smell of burning, or smoke, remove the power plug immediately and contact the service center. Causes electric shock, explosion and fire.
- ⚠ Do not put the battery on fire or heat it up. Causes heat and explosion.
- ⚠ Be sure to use a dedicated charger. Using another charger can cause fluid, heat and rupture.
- ⚠ Do not store or carry metal products such as necklaces and hair pins with batteries. Causes heat and / or explosion.
- ⚠ If your eyes come in contact with chemicals leaked out of the battery, wash them immediately with clean water and seek medical attention. Eyes will become damaged when untreated.
- ⚠ Wipe the battery with clean water immediately if the fluid is present on the skin or clothing. Leaving it alone will cause skin damage.
- ⚠ Never disassemble the external casing of the battery or damage the parts, or use a battery that has been dismantled or destroyed. Causes fluid, heat and explosion.
- ⚠ When charging the battery, stop charging immediately if charging is not completed even after a certain amount of charging time has elapsed. Causes heat and / or explosion.
- ⚠ Do not wet the battery. Causes heat and / or explosion.
- ⚠ Be sure to disconnect the battery from the device after using it. Causes chemicals to leak and / or overheating.
- 🔍 When disposing a battery, insulate the contact area with tape and dispose of the battery properly in accordance with the regulations of the local government in the residential area.

- ⚠ Do not bend, pull, or strain the power line of the charger. Causes electric shock and fire.
- ⚠ Plug the charger into the inner end to prevent it from shaking. Incomplete connection may cause fire.
- ⚠ Do not use damaged power lines, plugs, or loose socket outlets. Causes electric shock and fire.
- ⚠ Never touch the power plug of the charger with wet hands. Causes electric shock.
- ⚠ Keep the power line of the charger away from heat sources. The covering of the power supply may melt, causing fire or electric shock.
- ⚠ Do not plug several power plugs into one outlet at the same time. Causes overheating and / or fire.

Light Installation/Operation

- ⚠ Do not install in areas where there is oil, smoke, moisture, dust, or rainwater
- ⚠ If oil or moisture enters the inside, there is a risk of electric shock and fire.
- ⚠ Never turn the product on in front of people's and animals' eyes. Doing so may cause irreversible eye injury. Always attach the diffuser when filming people or infants, and be careful not to point the light at their eyes. Keep a minimum distance of 2 meters.
- ⚠ Do not turn on the lights for the driver of the vehicle in motion. Causes an accident.
- ⚠ Do not block the sidewalls and vents of the light. The LED module may experience reduced life and fire due to increased internal temperature.
- ⚠ Be sure to use only the specified external power supply and battery for the light. Use of random power may cause equipment failure and fire.
- ⚠ If the light has been lit for more than 5 minutes, there is a risk of low temperature burn if the light is held in the light for longer than 5 minutes, so wait until the light case cools down. Manipulate it.
- ⚠ If the light falls into the water or the casing is damaged, turn off the product and unplug the power supply. Failure to do so may cause fire and electric shock. Contact the Matrix Light Service Center.
- ⚠ Do not arbitrarily disassemble, repair, or modify the light. If you need repairs, please contact the service center.
- ⚠ Do not use or store flammable sprays or flammable substances near the product. There is a risk of explosion and / or fire.
- ⚠ Do not insert metal objects such as chopsticks, wire, or trunks into the ventilation shaft or power terminal, or fire-prone items such as paper or matches. There is a risk of electric shock and fire. If water or foreign matter is inside the unit, turn off the power switch on the main body of the machine, remove the power plug from the outlet, and contact the service center.
- ⚠ Avoid hot and humid places. Risk of failure and electric shock. There is also a risk of product failure and electric shock when used outside during thunder and lightning.
- ⚠ Do not use benzene or paint thinner to clean. Causes deformation and discoloration.
- ⚠ Keep small accessories out of the infant's reach. Infants may swallow them. If swallowed, consult your doctor immediately.
- ⚠ Don't touch it with wet hands. Causes electric shock.
- Store in a stable, well-ventilated place.

••• Product knowledge

04. Product package components •••

Make sure that all necessary accessories are included in your package before using the product. Depending on the type of package you purchased, the shape of the product configuration or accessories may vary.

Basic components •••

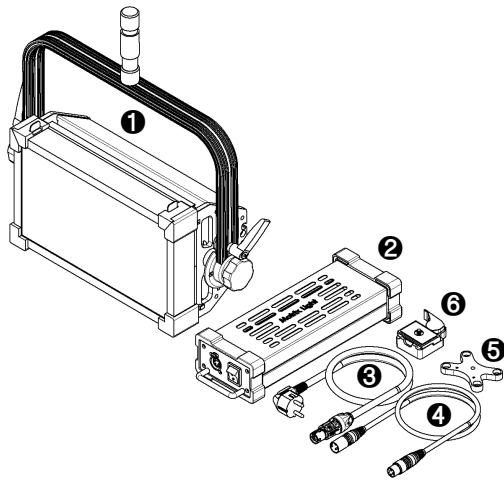

[All Light 1 Basic components]

- ❶ All Light 1 LED Light
- ❷ ML-APS1 Power Supply Unit
- ❸ ML-APC1 Power Cable
- ❹ ML-APC2 Power Cable
- ❺ ML-AT2 Power Supply Attachment
- ❻ ML-QR1 Quick release

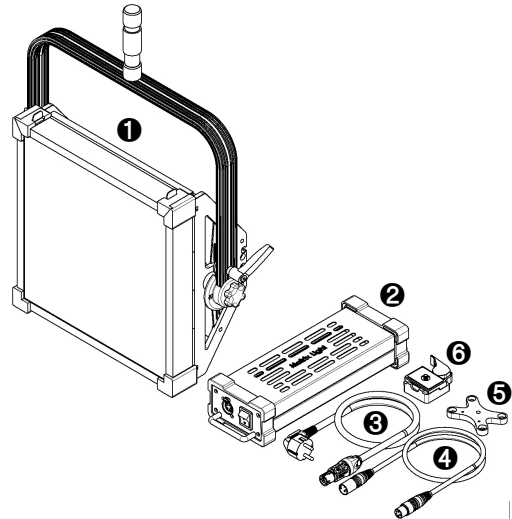

[All Light 2 Basic components]

- ❶ All Light 2 LED Light
- ❷ ML-APS2 Power Supply Unit
- ❸ ML-APC1 Power Cable
- ❹ ML-APC2 Power Cable
- ❺ ML-AT2 Power Supply Attachment
- ❻ ML-QR1 Quick release

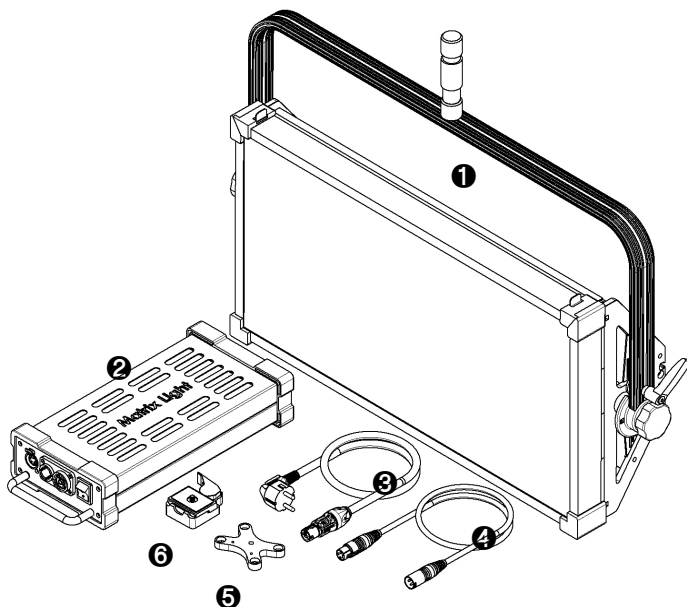

[All Light 4 Basic components]

- ❶ All Light 4 LED Light
- ❷ ML-APS4 Power Supply Unit
- ❸ ML-APC1 Power Cable
- ❹ ML-APC2 Power Cable
- ❺ ML-AT2 Power Supply Attachment
- ❻ ML-QR1 Quick release

Optional Parts ...

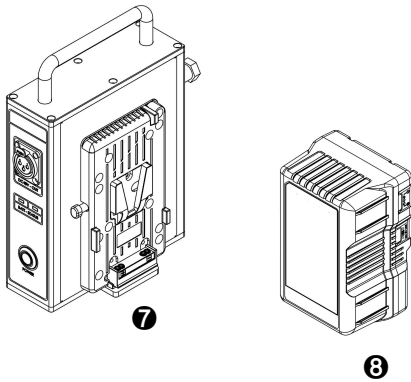
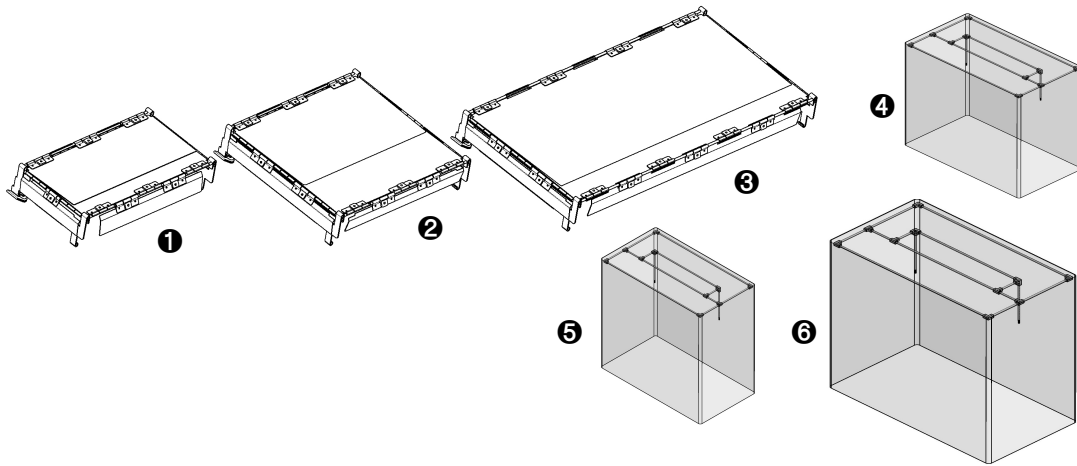

[Optional Parts]

- ❶ ML-ABD1 Barn Door for All Light 1
- ❷ ML-ABD2 Barn Door for All Light 2
- ❸ ML-ABD4 Barn Door for All Light 4
- ❹ ML-ARC1 Rain Cover for All Light 1
- ❺ ML-ARC2 Rain Cover for All Light 2
- ❻ ML-ARC4 Rain Cover for All Light 4
- ❼ ML-PB48 48V DC Power Supply
- ❽ ML-BP22A BP Battery

- Accessories in the package or optional devices can be purchased from www.matrixlight.com
- Revision of the user manual provided can be downloaded from the Matrix Light website at (www.matrixlight.com)
- Only use Matrix Light accessories (such as power cables, batteries, power supplies, etc). Damages caused from using third-party accessories are not eligible for free warranty service.

••• Name and function of each part

01. LED Light •••

[All Light 1]

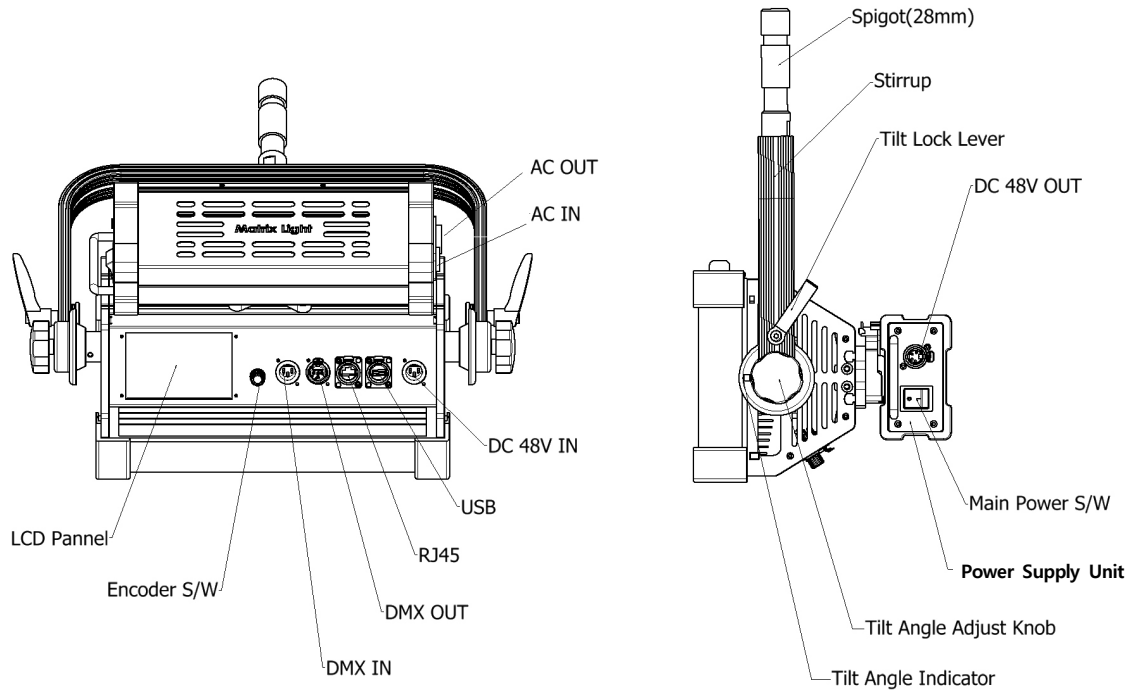

[All Light 2]

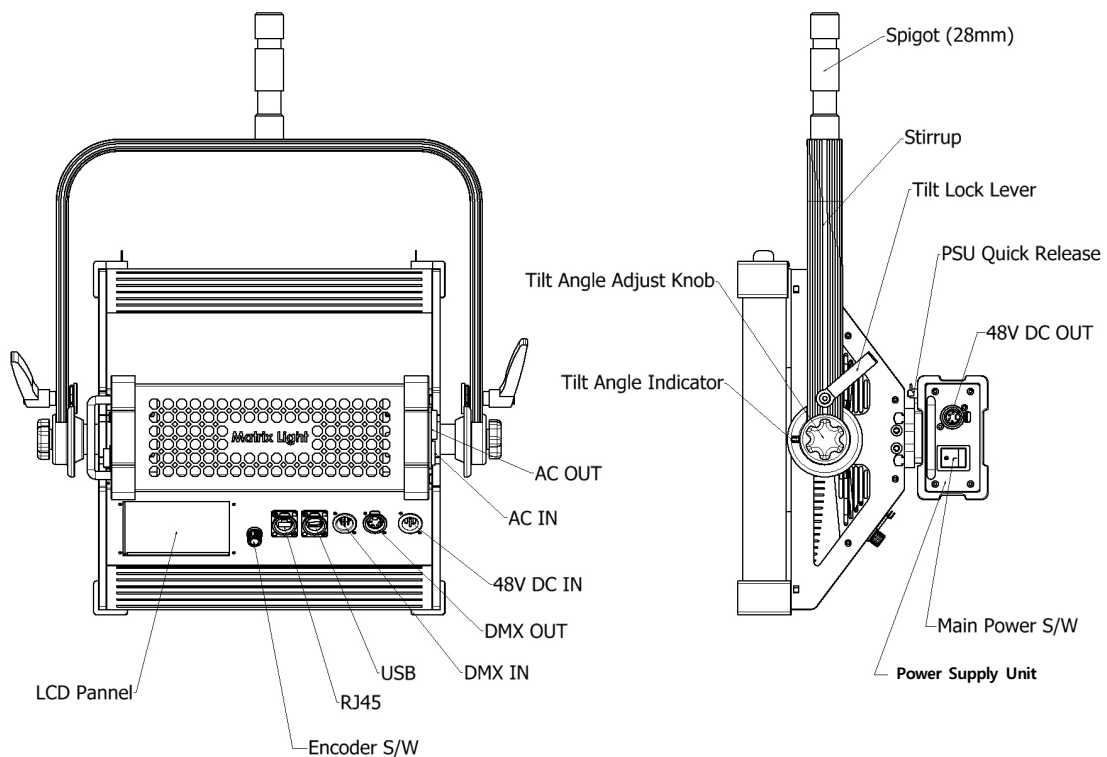

[All Light 4]

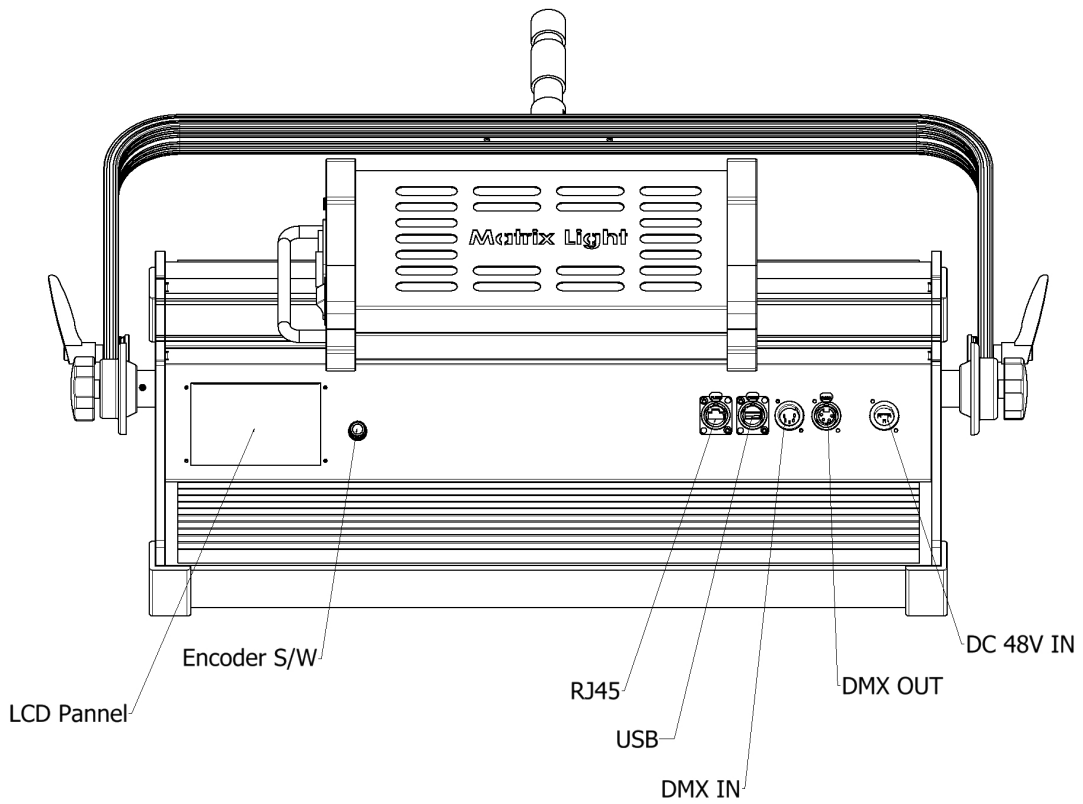
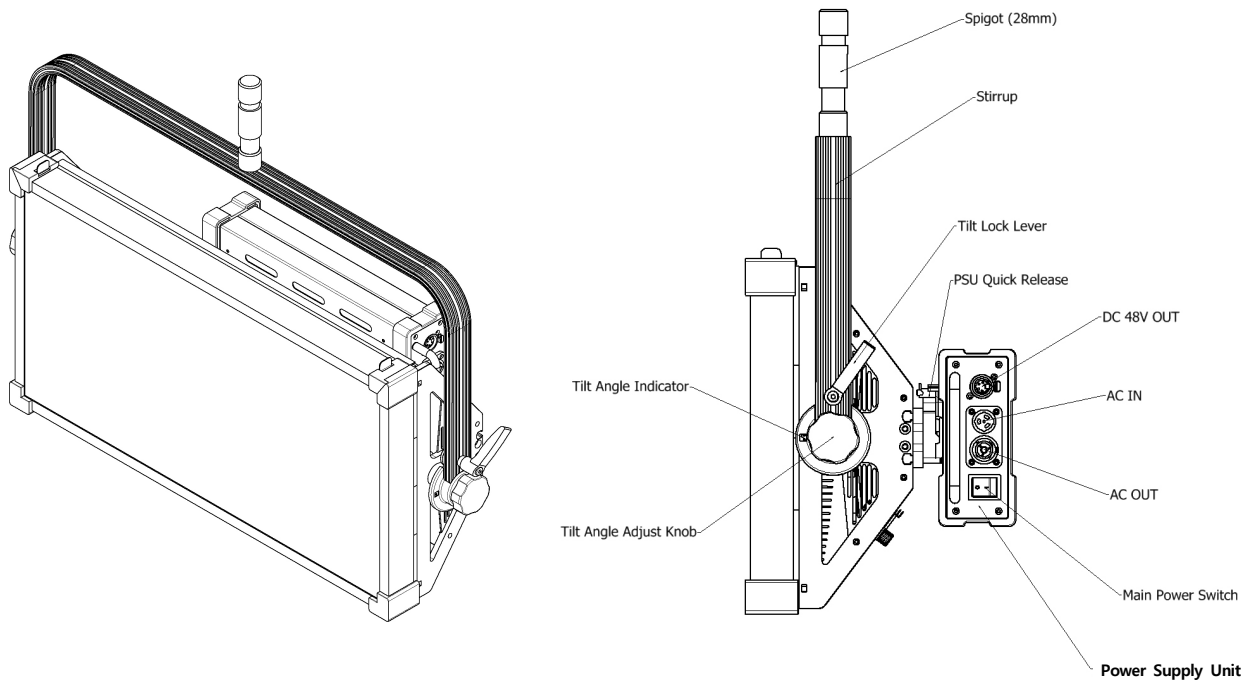

••• Installation and Use of Lights

01. How to Install and Use Light •••

Power Supply

AC Power

The Matrix Light All Light is powered by an external power supply (Power Supply Unit / PSU). The PSU is an automatic sense switch mode power supply that automatically adapts to AC power at 110 to 240 V and 50/60 Hz.

How to attach a power supply (PSU)

To attach an external power supply (PSU) to the Matrix Light All Light, push the external power supply (PSU) into the groove of the Quick Release installed behind the Matrix Light All Light as shown below. After attaching, pull the anti-departure lock lever of the Quick Release in the direction of the arrow to prevent the external power supply (PSU) from falling easily.

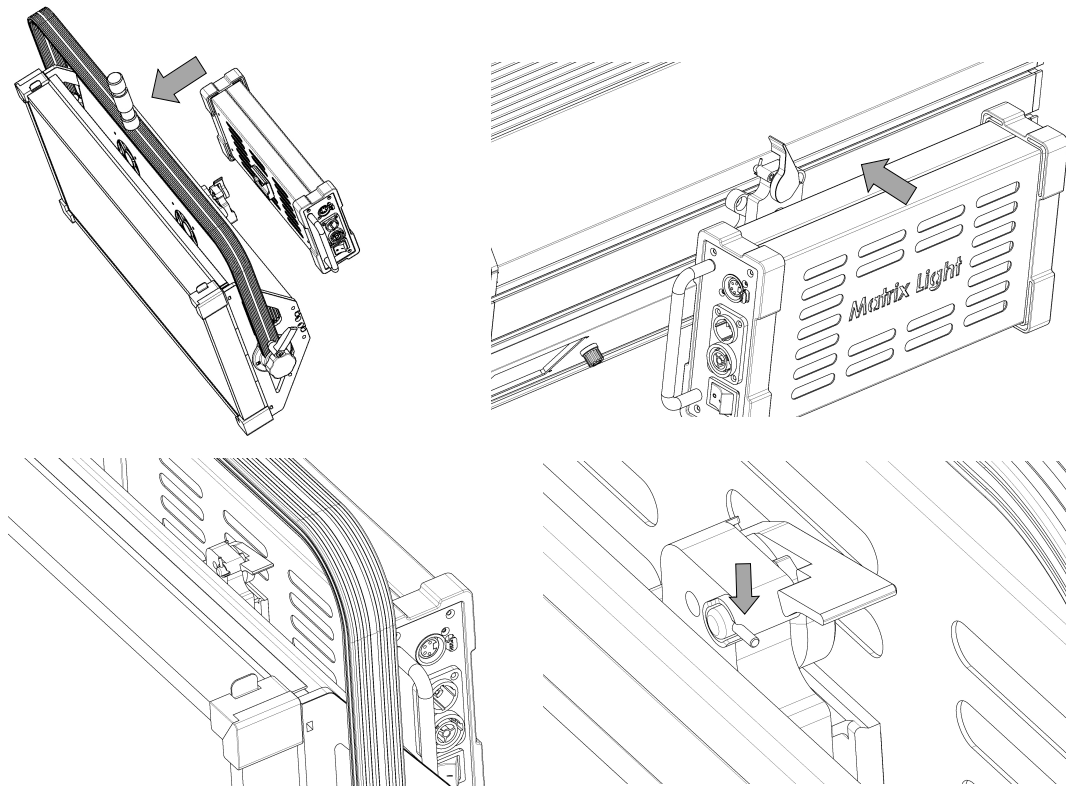

Do not stare closely at the light before connecting it to the power supply or battery pack. Make sure the product is disconnected from the DMX device. Also, make sure that the power switch on the external power supply (PSU) is turned off. Connecting the PSU to the light with the power switch on the external power supply (PSU) may strain the equipment and cause a failure. The power switch of the external power supply (PSU) must be turned on finally after all the power cables are connected properly.

The power outlet or external power switch that supplies the Matrix Light All Light must be located near the external power supply and the PSU must be easily disconnected or connected from the power source.

The external power supply of the Matrix Light All Light requires a Neutrik PowerCON True1 NAC3FX-W cable connector or a compatible power input cable. The Matrix Light provides a power cable with a different plug or end-to-end plug from the PowerCON cable connector for

110V or 240V voltage (see "Product Specification").

The connector cable between the external power supply and the Matrix Light All Light can be used in different lengths as an accessory. Use only connector cables for Matrix Light All Light (see "Product Specification").

To insert and remove PowerCON cable connectors

1. Arrange the key protrusion of the connector and the keyway of the input socket, then insert the cable connector into the power input socket.

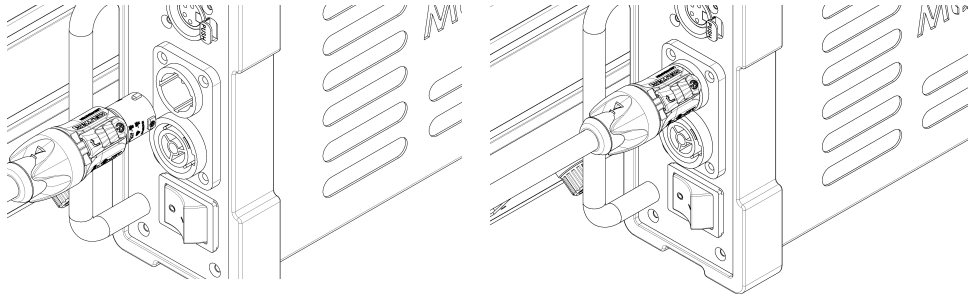

2. Lock the cable connector by turning it fully clockwise.
3. To unlock the cable connector, press the connector lock backward and turn the cable connector counterclockwise. Pull the cable connector out of the power input socket.

To connect and remove the XLR connector on the DC 48V cable

Connectivity to DC 48V cable connector:

1. Leave the main power switch on the external power supply OFF.
2. Align the 48 V DC power key on the socket of the product with the keyway on the arm cable connector. Insert into the power supply of the socket until the cable connector is locked.

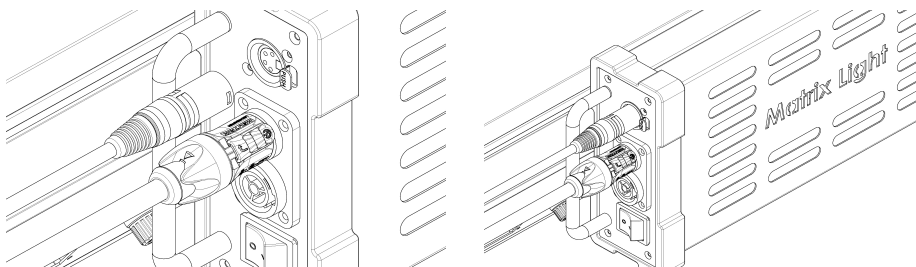

3. Align the raised key on the male cable connector with the keyway on the power supply outlet. Insert into the power outlet until the cable connector is locked.
4. Insert the arm cable connector into the DC 48V IN terminal of the All Light body.

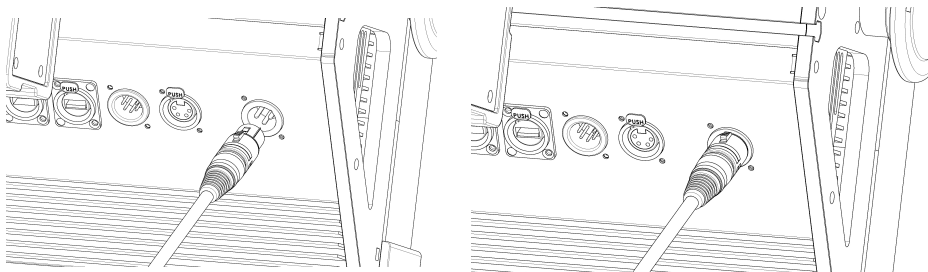

To disconnect the DC 48V cable connector:

1. Pull the connector lock and pull the cable connector out of the socket.

Power Through

The external power supply is equipped with a Neutrik PowerCON Through 1 power output socket, which can be supplied from one power outlet to another external power supply for the Matrix Light All Light. The voltage and frequency of the penetrating power is the same as the voltage and frequency of the power input.

External power supply power switch on/off

If the AC power input cable is connected to the external power supply and the lights are well connected to the dedicated cable, turn on the power switch of the external power supply. Turn off the power switch of the external power supply and release the power input cable when the lighting is finished.

Battery power

To operate the Matrix Light All Light using battery power, separate optional items such as ML-DPS1 / DC Power Supply Unit and ML-DPS1 exclusive BP batteries are required. If the battery is fully charged, combine the ML-DPS1 exclusive BP battery with the battery power supply (ML-DPS1 / DC Power Supply Unit) and connect the battery power supply and All Light to a dedicated power cable. Switch on the power switch of the battery power supply. Turn off the power switch of the battery power supply and release the power input cable when the lighting is finished.

How to use diffusion filters

Diffusion filters are installed in the product at the time of initial product purchase. If you replace the filter with a different spread ratio, proceed in the following order:

- Pull the upper cover latch on the left and right sides of the light upper cover to the direction of the arrow and open the upper cover.
- Pull out the previously installed diffused filter in the upward direction and insert the new diffused filter into the diffusion filter installation slot.
- Close the light upper cover and lock the upper cover by pushing the upper cover latch on the left and right sides to the direction of the arrow.

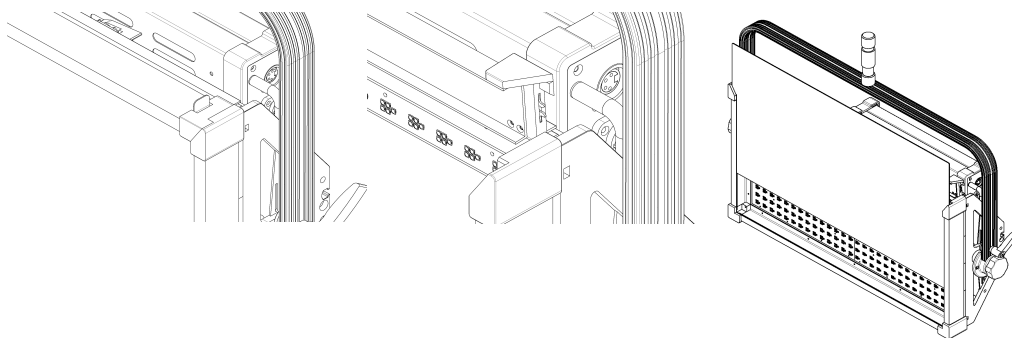

How to Use a Barn door

Barn door is available as a separate option.

The installation of the vanguard is to extend the small wings outwards to facilitate installation, as shown in the figure, and then mount them in the light in the order of the arrows. At this point, spread the fixing latch to the left and right to grooves, and at the bottom, place the bottom of the half-door into the "A" shaped shackle as illustrated, close the small wings to the light body and open the large wings to adjust the desired angle.

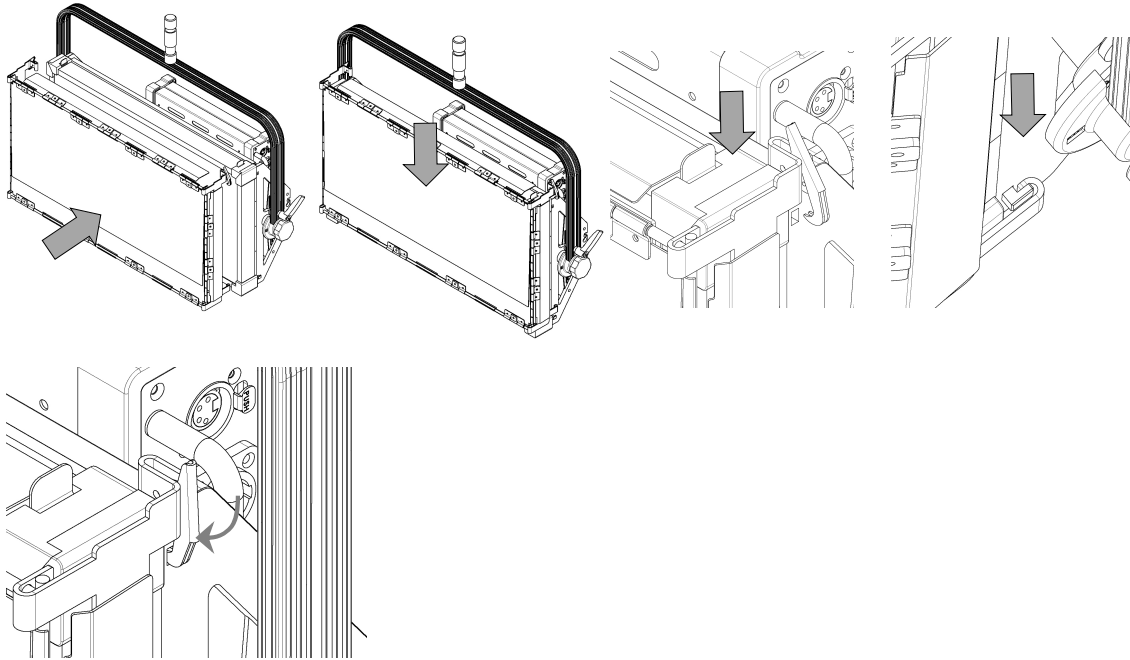

How to use a rain cover

The ML-ARC1, ML-ARC2, and ML-ARC4 rain cover are available as a separate option. Install the rain cover as shown in the figure below, rotate the two rods to fix them on the mounting screw groove for the run-in-cover rod. Install the rain cover frame using the connecting joint and rod, and cover the rain cover as shown below. Secure the rain cover to the body of the product with a retaining strap at the bottom of the rain cover to prevent the wind from blowing. (In severe wind conditions, excessive use of rain cover without safely securing the light tripod may cause damage to the equipment and damage to the equipment by the wind.)

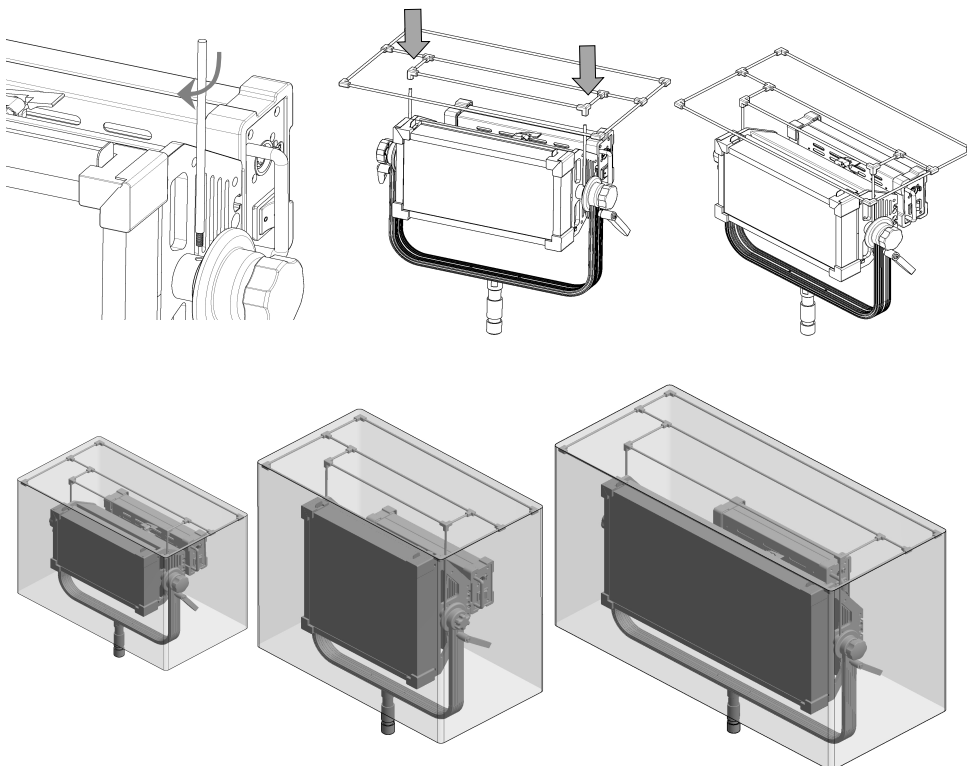

02. How to operate the touchscreen ...

Touchscreen menu configuration

The touchscreen menu of the Matrix Light All Light consists of the following schemes:

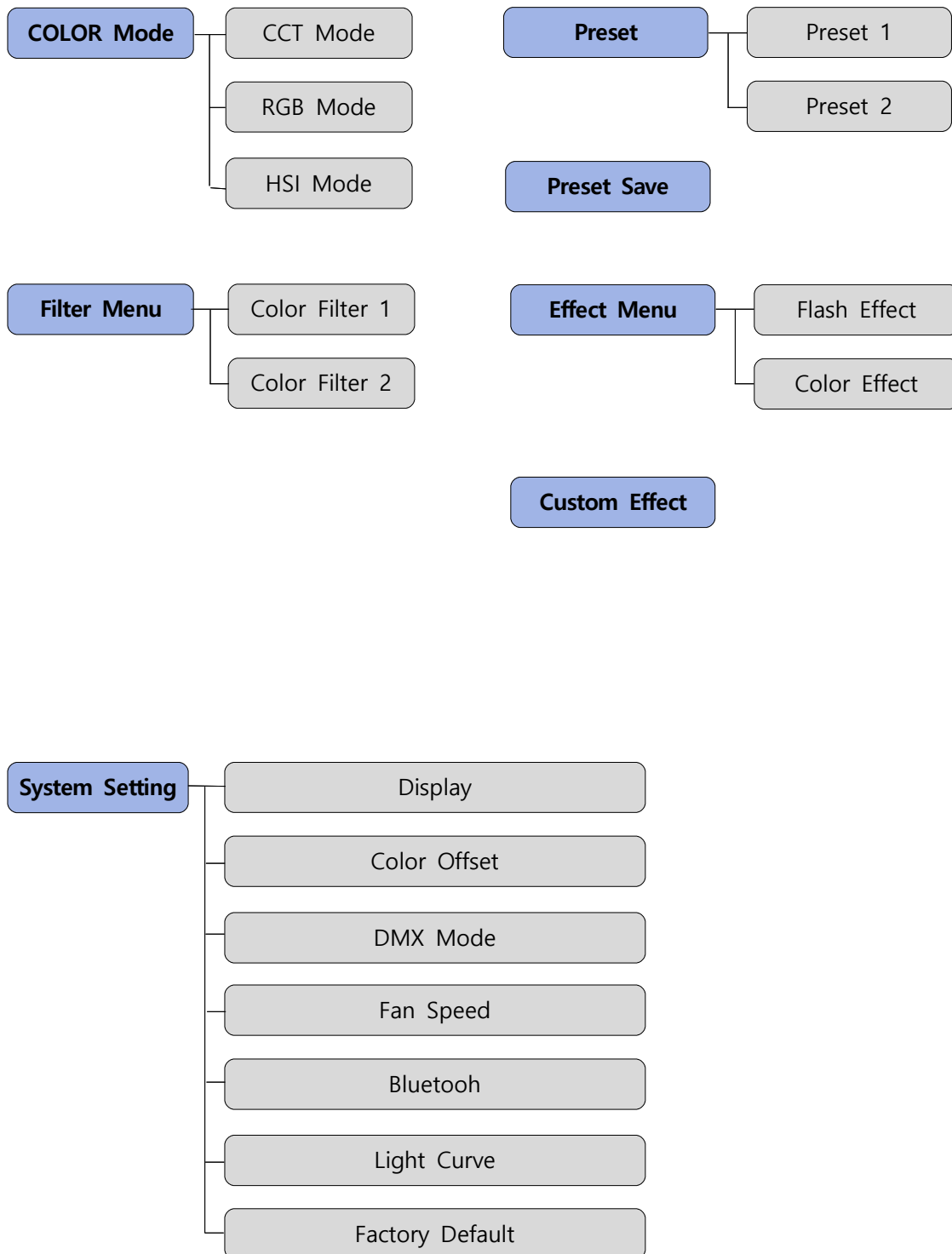

Touchscreen menu operation

The initial menu of the touchscreen for the Matrix Light All Light consists of the following:

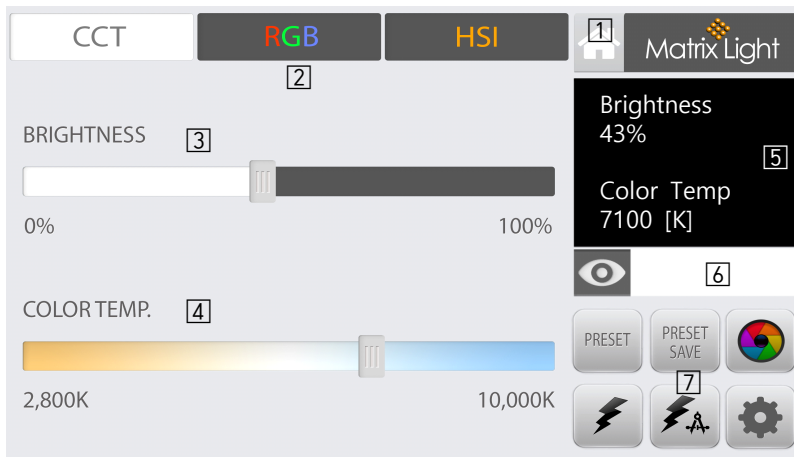

- 1 Home Button
- 2 Color Mode Button
- 3 Brightness Controller
- 4 Color Temp. Controller
- 5 Information Window
- 6 Color Preview
- 7 Function Select Button

1. Color Mode

Matrix Light All Light supports three color modes: CCT, RGB, and HSI. CCT mode supports between 2,800K and 10,000K white light, and RGB mode is a color combination of three-color LEDs from Red, Green and Blue that can produce tens of millions of different colors. HSI mode is a color combination based on Hue, Saturation and Intensity that allows you to express the desired color.

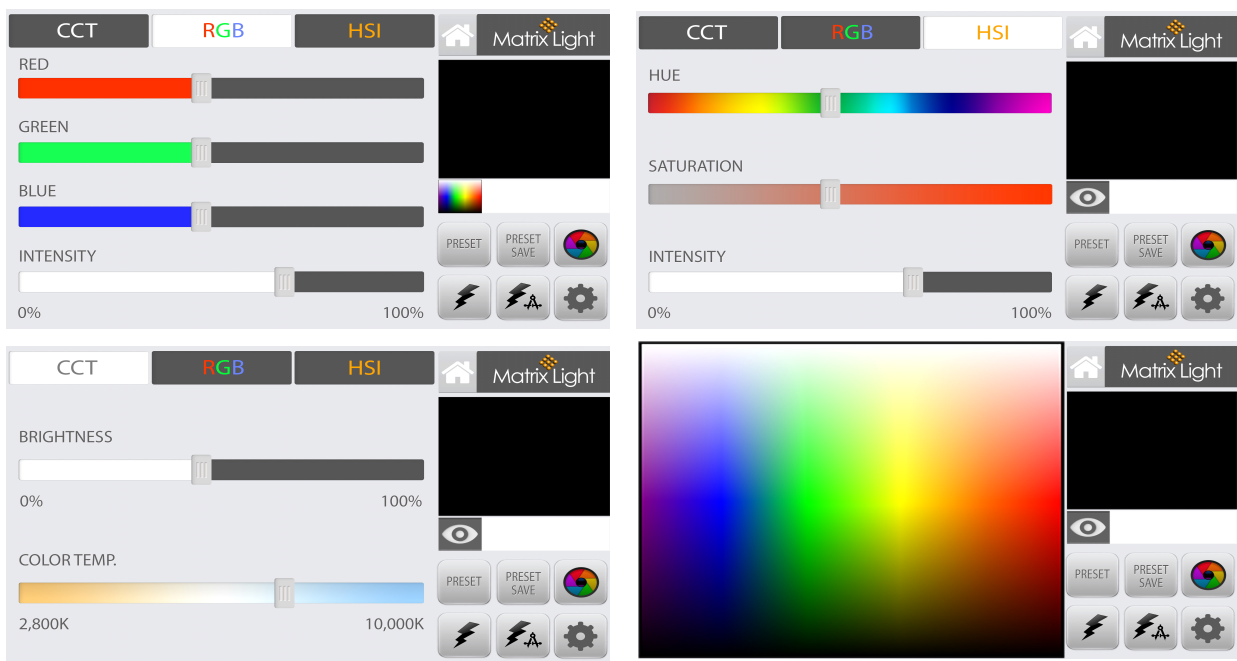

To vary the brightness or color in each color mode, drag the control bar of the touchscreen to the left or right or turn the Encoder Switch knob on the light body to fine-tune up to 0.1% units. In addition to these functions, the encoder switch also moves to each menu (turns left and right), selects (presses), and stores the current color setting (presses in the Preset menu for 3 seconds). In particular, RGB color mode supports color palettes. In RGB color mode, touch the color palette icon to display the color palette on the screen and change it to that color when you touch the color you want.

2. Preset Function

Frequently used colors are organized in the preset menu. Users can quickly select a color preset from this menu. Colors selected from the color modes can be stored in the preset menu.

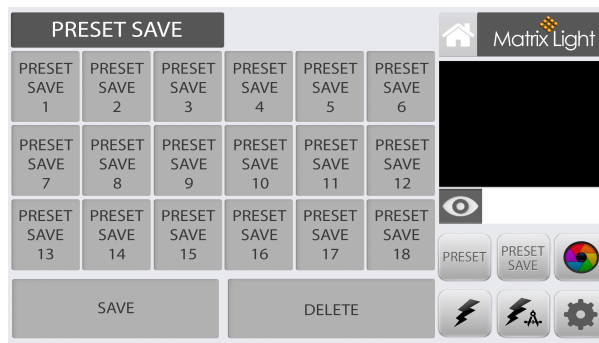
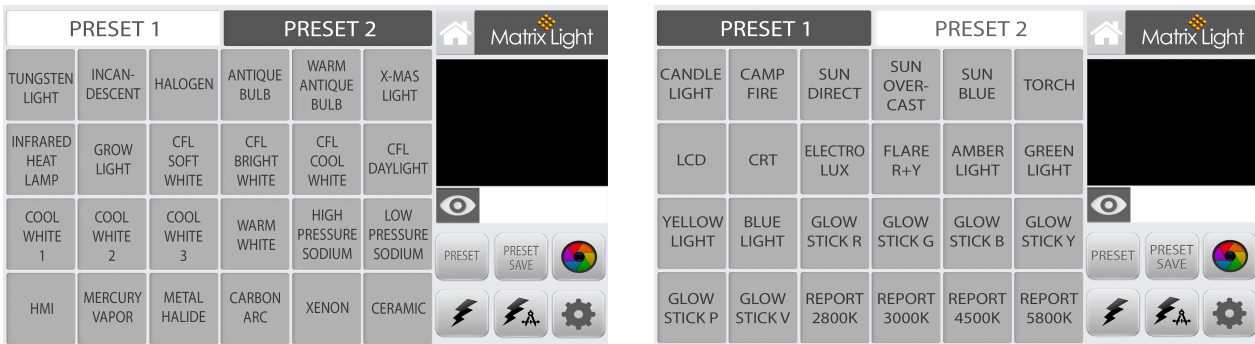

For example, if you want to save the color selected in color mode to a preset save menu, you can touch the SAVE button in the Preset Save menu and then touch the save position (for example, the Preset Save 1 button), which will save the color value you want to save and displays a dot of the color stored in the upper right corner of the button. To clear the color value, press DELETE and then press Preset to delete the stored data of that button.

3. Color Filter Menu

The Matrix Light All Light series contains specialized color filter data. It is divided into Color Filter 1 Group and Color Filter 2 Group, and the Color Filter 1 Group provides colors similar to most color filters from LEE Filter Company and the Color Filter 2 Group from Rosco Lux Company.

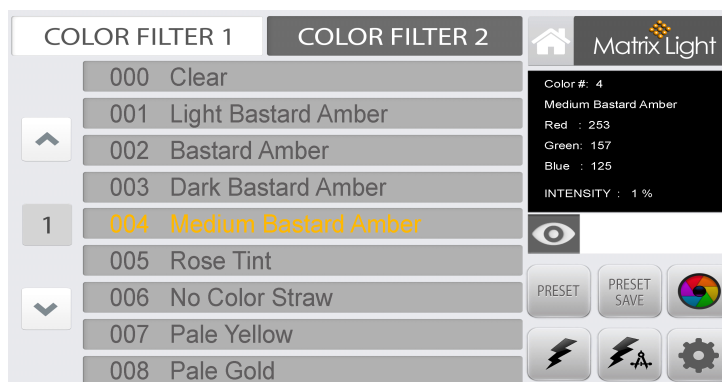

All Light provides 152 Color Filter 1 and 168 Color Filter 2 filter values. See the table below for detailed color filter names, pages where they are located, and color numbers for these filters.

| Classification | PAGE | AllLight# | Color # | Color Name | Transmission [%] |
|----------------|------|-----------|----------------------|----------------------|------------------|
| Color Filter 1 | 1 | 1 | 2 | Rose Pink | 33 |
| | | 2 | 3 | Lavender Tint | 75 |
| | | 3 | 4 | Medium Bastard Amber | 64 |
| | | 4 | 7 | Pale Yellow | 85 |
| | | 5 | 8 | Dark Salmon | 35 |
| | | 6 | 9 | Pale Amber Gold | 71 |
| | | 7 | 10 | Medium Yellow | 87 |
| | | 8 | 13 | Straw Tint | 72 |
| | | 9 | 15 | Deep Straw | 61 |
| | 2 | 1 | 19 | Fire | 19 |
| | | 2 | 20 | Medium Amber | 51 |
| | | 3 | 21 | Gold Amber | 31 |
| | | 4 | 22 | Dark Amber | 24 |
| | | 5 | 24 | Scarlet | 19 |
| | | 6 | 26 | Bright Red | 9 |
| | | 7 | 27 | Medium Red | 4 |
| | | 8 | 35 | Light Pink | 61 |
| | | 9 | 36 | Mesium Pink | 33 |
| | 3 | 1 | 46 | Dark Magenta | 6 |
| | | 2 | 48 | Rose Purple | 15 |
| | | 3 | 52 | Light Lavender | 45 |
| | | 4 | 53 | Paler Lavender | 62 |
| | | 5 | 58 | Lavender | 9 |
| | | 6 | 61 | Mist Blue | 62 |
| | | 7 | 63 | Pale Blue | 54 |
| | | 8 | 68 | Sky Blue | 13 |
| | | 9 | 79 | Just Blue | 6 |
| | 4 | 1 | 85 | Deeper Blue | 3 |
| | | 2 | 89 | Moss Green | 30 |
| | | 3 | 90 | Dark Yellow Green | 11 |
| | | 4 | 101 | Yellow | 80 |
| | | 5 | 102 | Light Amber | 75 |
| | | 6 | 103 | Straw | 82 |
| | | 7 | 104 | Deep Amber | 64 |
| | | 8 | 105 | Orange | 41 |
| | | 9 | 106 | Primary Red | 9 |
| | 5 | 1 | 107 | Light Rose | 48 |
| | | 2 | 109 | Light Salman | 55 |
| | | 3 | 110 | Middle Rose | 47 |
| | | 4 | 111 | Dark Pink | 32 |
| | | 5 | 113 | Magenta | 11 |
| | | 6 | 115 | Peacock Blue | 35 |
| | | 7 | 116 | Medium Blue-Green | 19 |
| | | 8 | 117 | Steel Blue | 55 |
| | | 9 | 118 | Light Blue | 24 |
| 6 | 1 | 119 | Dark Blue | 3 | |
| | 2 | 120 | Deep Blue | 1 | |
| | 3 | 121 | Color Filter 1 Green | 64 | |
| | 4 | 122 | Fern Green | 52 | |
| | 5 | 124 | Dark Green | 31 | |
| | 6 | 126 | Mauve | 4 | |
| | 7 | 127 | Smokey Pink | 12 | |
| | 8 | 128 | Bright Pink | 14 | |
| | 9 | 129 | Heavy Frost | 7 | |
| 7 | 1 | 130 | Clear | 95 | |
| | 2 | 132 | Medium Blue | 9 | |
| | 3 | 134 | Golden Amber | 38 | |

| Classification | PAGE | AllLight# | Color # | Color Name | Transmission [%] |
|----------------|------|-----------|--------------------|----------------------|------------------|
| | | 4 | 135 | Deep Golden Amber | 19 |
| | | 5 | 136 | Pale Lavender | 43 |
| | | 6 | 137 | Special Lavender | 26 |
| | | 7 | 138 | Pale Green | 80 |
| | | 8 | 139 | Primary Green | 15 |
| | | 9 | 141 | Bright Blue | 18 |
| | 8 | 1 | 142 | Pale Violet | 21 |
| | | 2 | 143 | Pale Navy Blue | 16 |
| | | 3 | 144 | No Colour Blue | 32 |
| | | 4 | 147 | Apricot | 53 |
| | | 5 | 148 | Bright Rose | 14 |
| | | 6 | 151 | Gold Tint | 69 |
| | | 7 | 152 | Pale Gold | 71 |
| | | 8 | 153 | Pale Salmon | 65 |
| | | 9 | 154 | Pale Rose | 73 |
| | 9 | 1 | 156 | Chocolate | 26 |
| | | 2 | 157 | Pink | 36 |
| | | 3 | 158 | Deep Orange | 30 |
| | | 4 | 159 | No Color Straw | 89 |
| | | 5 | 161 | Slate Blue | 25 |
| | | 6 | 162 | Bastard Amber | 78 |
| | | 7 | 164 | Flame Red | 18 |
| | | 8 | 165 | Daylight Blue | 20 |
| | | 9 | 166 | Pale Red | 25 |
| | 10 | 1 | 170 | Deep Lavender | 26 |
| | | 2 | 174 | Dark Steel Blue | 30 |
| | | 3 | 176 | Loving Amber | 50 |
| | | 4 | 179 | Chrome Orange | 54 |
| | | 5 | 180 | Dark Lavender | 7 |
| | | 6 | 181 | Congo Blue | 1 |
| | | 7 | 182 | Light Red | 11 |
| | | 8 | 183 | Moonlight Blue | 19 |
| | | 9 | 184 | Cosmetic Peach | 57 |
| | 11 | 1 | 185 | Cosmetic Burgundy | 52 |
| | | 2 | 186 | Cosmetic Silver Rose | 51 |
| | | 3 | 187 | Cosmetic Rouge | 54 |
| | | 4 | 188 | Cosmetic Highlight | 56 |
| | | 5 | 189 | Cosmetic Silver Moss | 61 |
| | | 6 | 190 | Cosmetic Emerald | 60 |
| | | 7 | 191 | Cosmetic Aqua Blue | 53 |
| | | 8 | 192 | Flesh Pink | 35 |
| | | 9 | 193 | Rosy Gold | 36 |
| | 12 | 1 | 194 | Surprise Pink | 22 |
| | | 2 | 195 | Zenith Blue | 3 |
| | | 3 | 196 | True Blue | 27 |
| | | 4 | 197 | Alice Blue | 10 |
| | | 5 | 200 | Double C.T. Blue | 16 |
| | | 6 | 201 | Full C.T. Blue | 34 |
| 7 | | 202 | 1/2 C.T. Blue | 55 | |
| 8 | | 203 | 1/4 C.T. Blue | 69 | |
| 9 | | 204 | Full C.T. Orange | 55 | |
| 13 | 1 | 205 | 1/2 C.T. Orange | 71 | |
| | 2 | 206 | 1/4 C.T. Orange | 79 | |
| | 3 | 207 | C.T. Orange +.3 ND | 32 | |
| | 4 | 208 | C.T. Orange +.6 ND | 16 | |
| | 5 | 209 | .3 ND | 51 | |
| | 6 | 210 | .6 ND | 24 | |
| | 7 | 211 | .9 ND | 14 | |
| | 8 | 212 | L.C.T. Yellow | 89 | |

| Classification | PAGE | AllLight# | Color # | Color Name | Transmission [%] | |
|----------------|----------------|-----------|--------------------|----------------------------------|----------------------|-----|
| Color Filter 2 | 14 | 9 | 213 | White Flame Green | 89 | |
| | | 1 | 218 | 1/8 C.T. Blue | 81 | |
| | | 2 | 219 | Color Filter 1 Fluorescent Green | 32 | |
| | | 3 | 223 | 1/8 C.T. Orange | 85 | |
| | | 4 | 226 | Color Filter 1 U.V. | 92 | |
| | | 5 | 230 | Super Correction L.C.T. Yellow | 42 | |
| | | 6 | 232 | Super White Flame | 37 | |
| | | 7 | 236 | H.M.I. To Tungsten | 58 | |
| | | 8 | 237 | C.I.D. To Tungsten | 39 | |
| | 9 | 238 | C.S.I. To Tungsten | 30 | | |
| | 15 | 1 | 241 | Color Filter 1 Fluorescent 5700K | 27 | |
| | | 2 | 242 | Color Filter 1 Fluorescent 4300K | 37 | |
| | | 3 | 243 | Color Filter 1 Fluorescent 3600K | 46 | |
| | | 4 | 244 | Color Filter 1 Plus Green | 74 | |
| | | 5 | 245 | Half Plus Green | 82 | |
| | | 6 | 246 | Quarter Plus Green | 85 | |
| | | 7 | 247 | Color Filter 1 Minus Green | 59 | |
| | | 8 | 248 | Half Minus Green | 72 | |
| | | 9 | 249 | Quarter Minus Green | 82 | |
| | 16 | 1 | 278 | Eighth Plus Green | 88 | |
| | | 2 | 279 | Eighth Minus Green | 87 | |
| | | 3 | 281 | 3/4 C.T. Blue | 46 | |
| | | 4 | 285 | 3/4 C.T. Orange | 61 | |
| | | 5 | 298 | .15 ND | 69 | |
| | | 6 | 299 | 1.2 ND | 7 | |
| | | 7 | 328 | Follies Pink | 20 | |
| | | 8 | 332 | Special Rose Pink | 11 | |
| | | 9 | 343 | Special Medium Lavender | 6 | |
| | 17 | 1 | 344 | Violet | 20 | |
| | | 2 | 353 | Lighter Blue | 41 | |
| | | 3 | 354 | Special Steel Blue | 39 | |
| | | 4 | 363 | Special Medium Blue | 4 | |
| | | 5 | 441 | Full C.T. Straw | 57 | |
| | | 6 | 442 | Half C.T. Straw | 71 | |
| | | 7 | 443 | Quarter C.T. Straw | 80 | |
| | | 8 | 444 | Eighth C.T. Straw | 83 | |
| | Color Filter 2 | 1 | 1 | 0 | Clear | 100 |
| | | | 2 | 1 | Light Bastard Amber | 56 |
| | | | 3 | 2 | Bastard Amber | 78 |
| | | | 4 | 3 | Dark Bastard Amber | 62 |
| | | | 5 | 4 | Medium Bastard Amber | 66 |
| | | | 6 | 5 | Rose Tint | 80 |
| | | | 7 | 6 | No Color Straw | 92 |
| | | | 8 | 7 | Pale Yellow | 96 |
| | | | 9 | 8 | Pale Gold | 86 |
| 2 | | 1 | 9 | Pale Amber Gold | 74 | |
| | | 2 | 10 | Medium Yellow | 92 | |
| | | 3 | 11 | Light Straw | 82 | |
| | | 4 | 12 | Straw | 88 | |
| | | 5 | 13 | Straw Tint | 78 | |
| | | 6 | 14 | Medium Straw | 68 | |
| | | 7 | 15 | Deep Straw | 65 | |
| | | 8 | 16 | Light Amber | 68 | |
| | | 9 | 17 | Light Flame | 56 | |
| 3 | | 1 | 18 | Flame | 56 | |
| | | 2 | 19 | Fire | 20 | |
| | | 3 | 20 | Medium Amber | 54 | |
| | | 4 | 21 | Golden Amber | 43 | |
| | | 5 | 22 | Deep Amber | 26 | |

| Classification | PAGE | AllLight# | Color # | Color Name | Transmission [%] | |
|----------------|------|-----------|---------|------------|--------------------|----|
| | | 6 | 23 | Orange | 32 | |
| | | 7 | 24 | Scarlet | 22 | |
| | | 8 | 25 | Orange Red | 14 | |
| | | 9 | 26 | Light Red | 12 | |
| | | 4 | 1 | 27 | Medium Red | 4 |
| | | | 2 | 30 | Light Salmon Pink | 44 |
| | | | 3 | 31 | Salmon Pink | 46 |
| | | | 4 | 32 | Medium Salmon Pink | 28 |
| | | | 5 | 33 | No Color Pink | 65 |
| | | | 6 | 34 | Flesh Pink | 45 |
| | | | 7 | 35 | Light Pink | 66 |
| | | | 8 | 36 | Medium Pink | 46 |
| | | | 9 | 37 | Pale Rose Pink | 56 |
| | | 5 | 1 | 38 | Light Rose | 49 |
| | | | 2 | 40 | Light Salmon | 34 |
| | | | 3 | 41 | Salmon | 24 |
| | | | 4 | 42 | Deep Salmon | 8 |
| | | | 5 | 43 | Deep Pink | 28 |
| | | | 6 | 44 | Middle Rose | 26 |
| | | | 7 | 45 | Rose | 8 |
| | | | 8 | 46 | Magenta | 6 |
| | | | 9 | 47 | Light Rose Purple | 16 |
| | | 6 | 1 | 48 | Rose Purple | 16 |
| | | | 2 | 49 | Medium Purple | 4 |
| | | | 3 | 50 | Mauve | 14 |
| | | | 4 | 51 | Surprise Pink | 54 |
| | | | 5 | 52 | Light Lavender | 26 |
| | | | 6 | 53 | Pale Lavender | 64 |
| | | | 7 | 54 | Special Lavender | 50 |
| | | | 8 | 55 | Lilac | 37 |
| | | | 9 | 56 | Gypsy Lavender | 4 |
| | | 7 | 1 | 57 | Lavender | 24 |
| | | | 2 | 58 | Deep Lavender | 10 |
| | | | 3 | 59 | Indigo | 2 |
| | | | 4 | 60 | No Color Blue | 62 |
| | | | 5 | 61 | Mist Blue | 66 |
| | | | 6 | 62 | Booster Blue | 54 |
| | | | 7 | 63 | Pale Blue | 56 |
| | | | 8 | 64 | Light Steel Blue | 26 |
| | | | 9 | 65 | Daylight Blue | 35 |
| | | 8 | 1 | 66 | Cool Blue | 67 |
| | | | 2 | 67 | Light Sky Blue | 26 |
| | | | 3 | 68 | Sky Blue | 14 |
| | | | 4 | 69 | Brilliant Blue | 18 |
| | | | 5 | 70 | Nile Blue | 45 |
| | | | 6 | 71 | Sea Blue | 30 |
| | | | 7 | 72 | Azure Blue | 44 |
| | | | 8 | 73 | Peacock Blue | 28 |
| | | | 9 | 74 | Night Blue | 4 |
| | | 9 | 1 | 76 | Light Green Blue | 9 |
| | | | 2 | 77 | Green Blue | 9 |
| | | | 3 | 78 | Trudy Blue | 19 |
| | | | 4 | 79 | Bright Blue | 8 |
| | | | 5 | 80 | Primary Blue | 9 |
| | | | 6 | 81 | Urban Blue | 10 |
| | | | 7 | 82 | Surprise Blue | 6 |
| | | | 8 | 83 | Medium Blue | 4 |
| | | | 9 | 84 | Zephyr Blue | 14 |
| | 10 | 1 | 85 | Deep Blue | 3 | |

| Classification | PAGE | AllLight# | Color # | Color Name | Transmission [%] |
|----------------|------|-----------|---------|------------------------------|------------------|
| | | 2 | 86 | Pea Green | 56 |
| | | 3 | 87 | Pale Yellow Green | 85 |
| | | 4 | 88 | Light Green | 82 |
| | | 5 | 89 | Moss Green | 45 |
| | | 6 | 90 | Dark Yellow Green | 13 |
| | | 7 | 91 | Primary Green | 7 |
| | | 8 | 92 | Turquoise | 59 |
| | | 9 | 93 | Blue Green | 35 |
| | | 11 | | 1 | 94 |
| 2 | 95 | | | Medium Blue Green | 15 |
| 3 | 96 | | | Lime | 98 |
| 4 | 97 | | | Light Grey | 50 |
| 5 | 98 | | | Medium Grey | 25 |
| 6 | 99 | | | Chocolate | 35 |
| 7 | 120 | | | Red Diffusion | 12 |
| 8 | 121 | | | Blue Diffusion | 8 |
| 9 | 122 | | | Green Diffusion | 13 |
| 12 | | 1 | 123 | Amber Diffusion | 32 |
| | | 2 | 124 | Red Cyc Silk | 12 |
| | | 3 | 125 | Blue Cyc Silk | 8 |
| | | 4 | 126 | Green Cyc Silk | 13 |
| | | 5 | 127 | Amber Cyc Silk | 32 |
| | | 6 | 128 | Magenta Silk | 6 |
| | | 7 | 129 | Sky Blue Silk | 14 |
| | | 8 | 130 | Medium Blue Green Silk | 15 |
| | | 9 | 131 | Medium Amber Silk | 54 |
| 13 | | 1 | 150 | Hamburg Rose | 80 |
| | | 2 | 151 | Hamburg Lavender | 26 |
| | | 3 | 152 | Hamburg Steel Blue | 26 |
| | | 4 | 304 | Pale Apricot | 79 |
| | | 5 | 305 | Rose Gold | 75 |
| | | 6 | 312 | Canary | 85 |
| | | 7 | 317 | Apricot | 51 |
| | | 8 | 321 | Soft Golden Amber | 39 |
| | | 9 | 337 | True Pink | 55 |
| 14 | | 1 | 339 | Broadway Pink | 15 |
| | | 2 | 342 | Rose Pink | 16 |
| | | 3 | 344 | Follies Pink | 21 |
| | | 4 | 355 | Pale Violet | 20 |
| | | 5 | 356 | Middle Lavender | 27 |
| | | 6 | 357 | Royal Lavender | 5 |
| | | 7 | 358 | Rose Indigo | 5 |
| | | 8 | 359 | Medium Violet | 5 |
| | | 9 | 378 | Alice Blue | 15 |
| 15 | | 1 | 383 | Sapphire Blue | 4 |
| | | 2 | 385 | Royal Blue | 4 |
| | | 3 | 388 | Gaslight Green | 76 |
| | | 4 | 389 | Chroma Green | 40 |
| | | 5 | 397 | Pale Grey | 70 |
| | | 6 | 3102 | Tough MT2 | 66 |
| | | 7 | 3106 | Tough MTY | 57 |
| | | 8 | 3107 | Tough Y-1 | 93 |
| | | 9 | 3114 | Tough UV Filter | 93 |
| 16 | | 1 | 3134 | Tough MT 54 | 83 |
| | | 2 | 3202 | Full Blue (CTB) | 36 |
| | | 3 | 3203 | Three-Quarter Blue (3/4 CTB) | 41 |
| | | 4 | 3204 | Half Blue (1/2 CTB) | 52 |
| | | 5 | 3206 | Third Blue (1/3 CTB) | 64 |
| | | 6 | 3208 | Quarter Blue (1/4 CTB) | 74 |

| Classification | PAGE | AllLight# | Color # | Color Name | Transmission [%] |
|----------------|------|-----------|---------|-------------------------------|------------------|
| | | 7 | 3216 | Eighth Blue (1/8 CTB) | 81 |
| | | 8 | 3220 | Double Blue (2x CTB) | 10 |
| | | 9 | 3304 | Tough Plusgreen / WindowGreen | 76 |
| | 17 | 1 | 3308 | Tough Minusgreen | 55 |
| | | 2 | 3310 | Fluorofilter | 36 |
| | | 3 | 3313 | Tough 1/2 Minusgreen | 71 |
| | | 4 | 3314 | Tough 1/4 Minusgreen | 81 |
| | | 5 | 3315 | Tough 1/2 Plusgreen | 90 |
| | | 6 | 3316 | Tough 1/4 Plusgreen | 92 |
| | | 7 | 3317 | Tough 1/8 Plusgreen | 93 |
| | | 8 | 3318 | Tough 1/8 Minusgreen | 89 |
| | | 9 | 3401 | Color Filter 2Sun 85 | 58 |
| | 18 | 1 | 3402 | Color Filter 2 N.3 | 50 |
| | | 2 | 3403 | Color Filter 2 N.6 | 25 |
| | | 3 | 3404 | Color Filter 2 N.9 | 12 |
| | | 4 | 3405 | Color Filter 2Sun 85N.3 | 33 |
| | | 5 | 3406 | Color Filter 2Sun 85N.6 | 17 |
| | | 6 | 3407 | Color Filter 2Sun (CTO) | 47 |
| | | 7 | 3408 | Color Filter 2Sun (1/2 CTO) | 73 |
| | | 8 | 3409 | Color Filter 2Sun (1/4 CTO) | 81 |
| | | 9 | 3410 | Color Filter 2Sun (1/8 CTO) | 92 |
| | 19 | 1 | 3411 | Color Filter 2Sun (3/4 CTO) | 58 |
| | | 2 | 3415 | Color Filter 2 N.15 | 70 |
| | | 3 | 3441 | Full Straw (CTS) | 50 |
| | | 4 | 3442 | Half Straw (1/2 CTS) | 73 |
| | | 5 | 3443 | Quarter Straw (1/4 CTS) | 81 |
| | | 6 | 3444 | Eighth Straw (1/8 CTS) | 92 |
| | | 7 | 3761 | Color Filter 2lex 85 | 58 |

4. Effect Menu

The Matrix Light All Light series supports a wide variety of effects, and if you need a new effect in addition to the existing one, you can create your own unique effect using the Custom Effect feature.

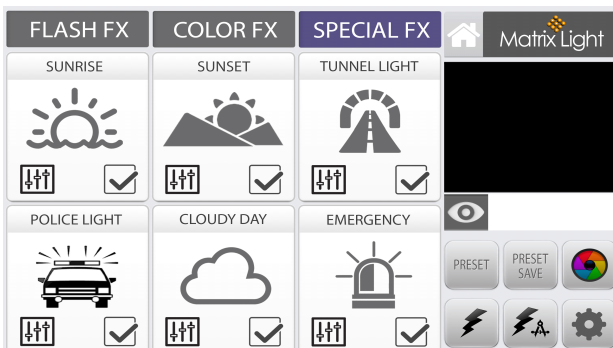
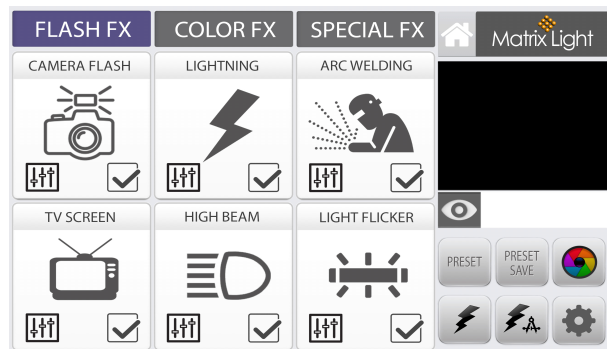
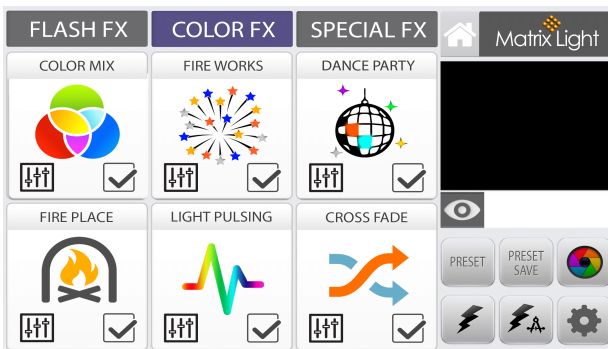

To select an effect, touch the corresponding effect menu button in the effect menu. The detailed type of effect for each effect is displayed in the information window by pressing the mode icon () in the lower right corner of the icon. To select a detailed effect and then adjust its brightness, you can adjust the brightness of the effect by turning the Encoder Switch on the light body to the desired amount. The brightness of the selected effect is displayed in the information window. To play the effect, simply press the

Apply icon () in the lower left corner of the icon. If you want to adjust the regeneration cycle of the effect, you can rotate the Encoder switch on the light body to adjust the desired length of the effect while the effect is playing.

While the effect is playing, the touchscreen functions are suspended to prevent sudden interruption of effect effects due to external interference. To stop the effect, press the encoder switch once.

Custom Effect Menu is a menu that allows you to create and use your own effects when you need new ones that are not already available. To use, select one of the buttons M1, M2, M3 (by default, M1 is selected), select the color desired by the users of R, G, and B colors, press the + button, and press the + button to create a control point at that location on the graph screen. This adjustment point can be dragged up and down, and to create additional adjustment points, press the + button again and press the desired position on the graph screen.

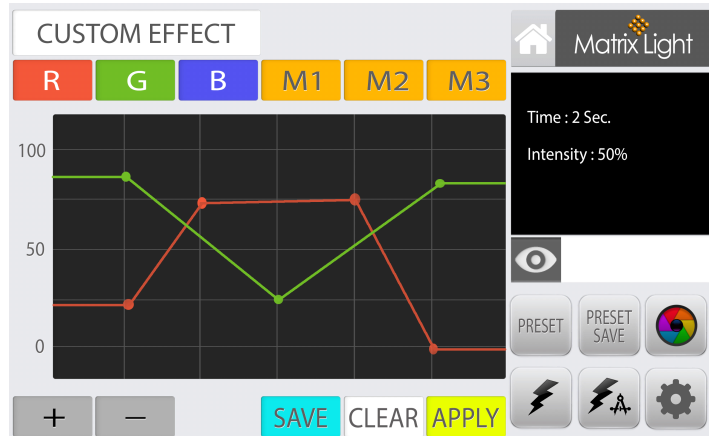

To delete a generated adjustment point, press the –button and touch the adjustment point you want to delete. Up to 15 control points can be created per R,G,B color, and all are deleted at once by pressing the Clear button. These control points appear in a curve graph. The horizontal axis of the graph represents the time of effect effects, and the vertical axis of the graph represents the brightness of the color R,G,B.

The effect can be changed up to 10 seconds in 0.1 second intervals by turning the encoder switch, and the effect will be repeated indefinitely from the beginning at the end of the specified time. The brightness of the effect can be adjusted in 1% intervals by pressing the Encoder button once and turning the button. This created effect is created by pressing the Apply button to create that effect in the light.

When the Save button is pressed, the effect is saved to the currently selected button of the M1, M2, M3 buttons. To create and save a new effect on another button, you can first select an unselected button from the M1, M2, M3 buttons and create an adjustment point to create an effect and touch the Save button.

5. System Settings Menu

The system setting menu consists of seven items.

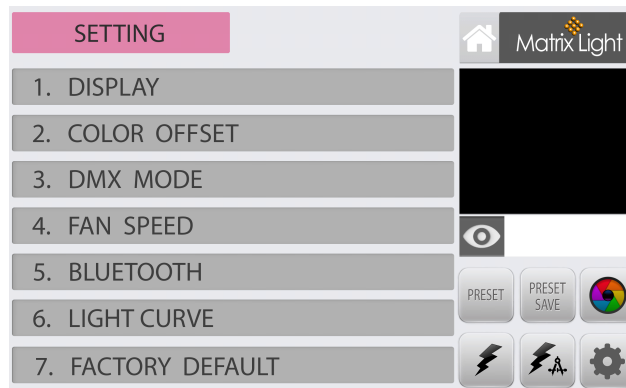

1) DISPLAY

You can set the brightness of the touch LCD panel display.

2) COLOR OFFSET

Green / Magenta points can be set to make the light more natural in the CCT mode of the LED light.

3) DMX MODE

You can set the DMX mode to 8 or 16Bit schemes, and you can set the DMX channel for all light lights.

4) FAN SPEED

You can set the number of rotations in the cooling fan in 10 steps. When Auto Mode is set, the fan automatically determines the number of rotations by checking the temperature of the instrument detected by the temperature sensor.

5) BLUETOOTH

To help distinguish between multiple All Lights, you can set 8 unique Bluetooth IDs for All Light from Matrix 01 to Matrix 08.

6) LIGHT CURVE

Light Curve sets the basic dimming curve of All Light. Light Curve has Linear Curve, Exponential Curve, Logarithmic Curve, and S Curve. The curves are as follows.

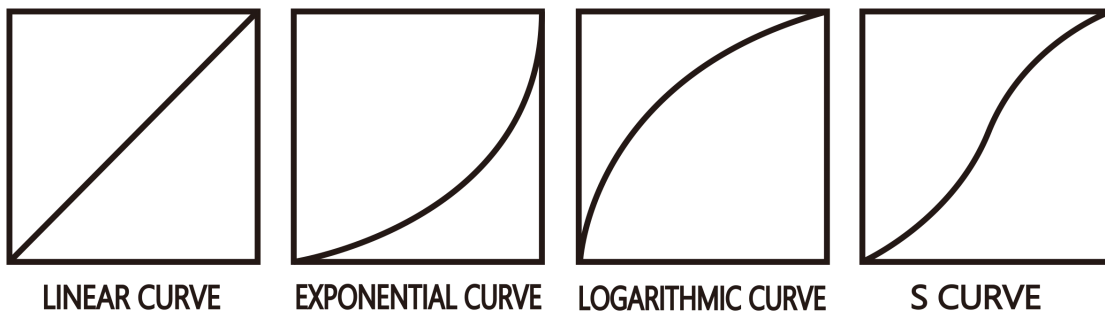

- LINEAR CURVE: The strength changes relative to the brightness value entered by the encoder or touchpanel.
- EXPONENTIAL CURVE: High at low resolution and low at high strength.
Used when high resolution is required at low intensity levels.
- LOGARITHMIC CURVE: The resolution is low at low intensity and high at high strength.
Use it when high resolution is required at high strength level.
- S CURVE: Resolution is high at both low and high strength levels.
Use this dimming curve when high resolution is required at low and high intensity levels.

7) Factory Default

This function initializes all user settings in All Light. The number shown in the information window on the right indicates the time of use of the product. After a period of time, check the instrument according to the items of regular maintenance.

03. DMX Menu ...

The DMX menu of the Matrix Light All Light consists of the following.

| | |
|--|--|
| 8 bit 1 channel per function | 16 bit 2 channels per function |
| DMX mode 1 | DMX mode 2 |

| All Light DMX Settings | | | | | |
|------------------------|---------|--|--|--|--|
| 8Bit | | | | | |
| MODE | CHANNEL | FUNCTION | VALUE | % | Notes |
| CCT | C+0 | DIMMER | 0-255 | 0-100 | Channel set 1 - 506 |
| | C+1 | CCT | 0-255 | 0-100 | 2800K - 10000K |
| | C+2 | ±GREEN | 0-10 11-20 21-119 120-145 146-244 245-255 | 0-4 4-8 8-47 47-57 57-96 96-100 | NO OffSet (0 Green) -100 Green -99 to -1 Green No OffSet (0 Green) +1 to +99 Green +100 Green |
| | C+3 | Reserved | | | |
| | C+4 | Reserved | | | |
| | C+5 | CCT RGBW HSI Preset Filter Effect | 0-42 43-85 86-127 128-170 171-212 213-255 | 0-16 17-33 34-50 51-66 67-83 84-100 | |
| | C+6 | FAN | 0-127 128-255 | 0-50 50-100 | Low speed Auto Fan |
| RGBW | C+0 | DIMMER | 0-255 | 0-100 | Channel set 1 - 506 |
| | C+1 | RED | 0-255 | 0-100 | |
| | C+2 | GREEN | 0-255 | 0-100 | |
| | C+3 | BLUE | 0-255 | 0-100 | |
| | C+4 | WARM | 0-255 | 0-100 | |
| | C+5 | CCT RGBW HSI Preset Filter Effect | 0-42 43-85 86-127 128-170 171-212 213-255 | 0-16 17-33 34-50 51-66 67-83 84-100 | |
| | C+6 | FAN | 0-127 128-255 | 0-50 50-100 | Low speed Auto Fan |
| H S I | C+0 | DIMMER | 0-255 | 0-100 | Channel set 1 - 506 |
| | C+1 | HUE | 0-255 | 0-100 | 0-360° |
| | C+2 | Saturation | 0-255 | 0-100 | |
| | C+3 | Reserved | | | |
| | C+4 | Reserved | | | |
| | C+5 | CCT RGBW HSI Preset Filter Effect | 0-42 43-85 86-127 128-170 171-212 213-255 | 0-16 17-33 34-50 51-66 67-83 84-100 | |
| | C+6 | FAN | 0-127 128-255 | 0-50 50-100 | Low speed Auto Fan |
| Preset | C+0 | DIMMER | 0-255 | 0-100 | Channel set 1 - 506 |
| | C+1 | FACTORY / USER MANU | 0-5 6-130 131-255 | 0-1 2-51 51-100 | Preset Trigger Disabled User Preset Selected Factory Preset Selected |
| | C+2 | PRESET SELECT | 0-42 43-85 86-127 128-170 | 0-16 17-33 34-50 51-66 | Preset # 1 Preset # 2 Preset # 3 Preset # 4 |

| All Light DMX Settings | | | | | |
|------------------------|---------|---|---|---|--|
| 8Bit | | | | | |
| MODE | CHANNEL | FUNCTION | VALUE | % | Notes |
| | | | 171-212 213-255 | 67-83 84-100 | Preset # 5 Preset # 6 |
| | C+3 | PRESET SELECT 2 | 0-31 32-63 64-95 96-127 128-159 160-191 192-223 224-255 | 0-12.5 12.5-25 25-37.5 37.5-50 50-62.5 62.5-75 75-87.5 87.5-100 | Preset Page # 1 (User, Factory Preset) Preset Page # 2 (User, Factory Preset) Preset Page # 3 (User, Factory Preset) Preset Page # 4 (User, Factory Preset) Preset Page # 5 (Only Factory Preset) Preset Page # 6 (Only Factory Preset) Preset Page # 7 (Only Factory Preset) Preset Page # 8 (Only Factory Preset) |
| | C+4 | Reserved | | | |
| | C+5 | CCT RGBW HSI Preset Filter Effect | 0-42 43-85 86-127 128-170 171-212 213-255 | 0-16 17-33 34-50 51-66 67-83 84-100 | |
| | C+6 | FAN | 0-127 128-255 | 0-50 50-100 | Low speed Auto Fan |
| Filter | C+0 | DIMMER | 0-255 | 0-100 | Channel set 1 - 506 |
| | C+1 | No Filter Color Filter 1 Color Filter 2LUX | 0-5 6-130 131-255 | 0-1 2-51 51-100 | Gel Trigger Disabled Color Filter 1 Filters Selected Color Filter 2lux Selected |
| | C+2 | FILTER SELECT | 0-28 29-56 57-84 85-112 113-140 141-168 169-196 197-224 225-255 | 0-10 11-21 22-32 33-43 44-54 55-65 66-76 77-87 88-100 | FILTER # 1 FILTER # 2 FILTER # 3 FILTER # 4 FILTER # 5 FILTER # 6 FILTER # 7 FILTER # 8 FILTER # 9 |
| | C+3 | FILTER PAGE | 0-13 14-26 27-39 40-52 53-65 66-78 79-91 92-104 105-117 118-130 131-143 144-156 157-169 170-182 183-195 196-208 209-221 222-234 235-255 | 0-5 5-10 10-15 15-20 20-25 26-31 31-36 36-41 41-46 46-51 51-56 56-61 61-66 66-71 71-76 77-82 82-87 87-92 92-100 | Filter Page # 1 (Color Filter 1, Color Filter 2) Filter Page # 2 (Color Filter 1, Color Filter 2) Filter Page # 3 (Color Filter 1, Color Filter 2) Filter Page # 4 (Color Filter 1, Color Filter 2) Filter Page # 5 (Color Filter 1, Color Filter 2) Filter Page # 6 (Color Filter 1, Color Filter 2) Filter Page # 7 (Color Filter 1, Color Filter 2) Filter Page # 8 (Color Filter 1, Color Filter 2) Filter Page # 9 (Color Filter 1, Color Filter 2) Filter Page # 10 (Color Filter 1, Color Filter 2) Filter Page # 11 (Color Filter 1, Color Filter 2) Filter Page # 12 (Color Filter 1, Color Filter 2) Filter Page # 13 (Color Filter 1, Color Filter 2) Filter Page # 14 (Color Filter 1, Color Filter 2) Filter Page # 15 (Color Filter 1, Color Filter 2) Filter Page # 16 (Color Filter 1, Color Filter 2) Filter Page # 17 (Color Filter 1, Color Filter 2) Filter Page # 18 (Only Color Filter 2) Filter Page # 19 (Only Color Filter 2) |
| | C+4 | Reserved | | | |
| | C+5 | CCT RGBW HSI Preset Filter Effect | 0-42 43-85 86-127 128-170 171-212 213-255 | 0-16 17-33 34-50 51-66 67-83 84-100 | |
| | C+6 | FAN | 0-127 128-255 | 0-50 50-100 | Low speed Auto Fan |
| | C+0 | DIMMER | 0-255 | 0-100 | Channel set 1 - 506 |
| | C+1 | PERIOD | 0-255 | 0-100 | Adjust the Period |
| Effect | C+2 | 1~6 | 0-42 43-85 86-127 128-170 171-212 213-255 | 0-16 17-33 34-50 51-66 67-83 84-100 | <FLASH> 1.Camera, 2.Lightning, 3.ARC 4.TV, 5.High Beam, 6.Light Flicker <COLOR> 1.Color Mix, 2.Fire Works, 3.Party 4.Fire, 5.Light Pulsing, 6.Cross Fade |

| All Light DMX Settings | | | | | |
|------------------------|---------|--|--|--|--|
| 8Bit | | | | | |
| MODE | CHANNEL | FUNCTION | VALUE | % | Notes |
| | | | | | <SPECIAL> 1.Sunrise, 2.Sunset, 3.Tunnle 4. Police, 5.Cloudy, 6.Emergency |
| | C+3 | FX Mode | 0-85 86-170 171-255 | 0-33 33-67 67-100 | Select Action Mode 1-3 |
| | C+4 | FLASH COLOR SPECIAL | 0-85 86-170 171-255 | 0-33 33-67 67-100 | Select Effect <FLASH>,<COLOR>,<SPECIAL> |
| | C+5 | CCT RGBW HSI Preset Filter Effect | 0-42 43-85 86-127 128-170 171-212 213-255 | 0-16 17-33 34-50 51-66 67-83 84-100 | |
| | C+6 | FAN | 0-127 128-255 | 0-50 50-100 | Low speed Auto Fan |

| All Light DMX Settings | | | | | |
|------------------------|--|--|--|--|--|
| 16Bit | | | | | |
| MODE | CHANNEL | FUNCTION | VALUE | % | Notes |
| CCT | C+0(H) | DIMMER | 0-65535 | 0-100 | Channel set 1 - 501 |
| | C+1(L) | | | | |
| | C+2(H) | CCT | 0-65535 | 0-100 | 2800K - 10000K |
| | C+3(L) | | | | |
| | C+4(H) | ±GREEN | 0-5000 5001-10000 10001-29999 30000-40000 40001-59999 60000-65535 | 0-7 8-15 16-46 46-61 61-92 92-100 | NO color (0 Green) -100 Green -99 to -1 Green No color (0 Green) +1 to +99 Green +100 Green |
| | C+5(L) | | | | |
| | C+6 | Reserved | | | |
| | C+7 | Reserved | | | |
| | C+8 | Reserved | | | |
| | C+9 | Reserved | | | |
| | C+10 | FAN | 0-127 128-255 | 0-50 50-100 | Low speed Auto Fan |
| C+11 | CCT RGBW HSI Preset Filter Effect | 0-42 43-85 86-127 128-170 171-212 213-255 | 0-16 17-33 34-50 51-66 67-83 84-100 | | |
| RGBW | C+0(H) | DIMMER | 0-65535 | 0-100 | Channel set 1 - 501 |
| | C+1(L) | | | | |
| | C+2(H) | RED | 0-65535 | 0-100 | |
| | C+3(L) | | | | |
| | C+4(H) | GREEN | 0-65535 | 0-100 | |
| | C+5(L) | | | | |
| | C+6(H) | BLUE | 0-65535 | 0-100 | |
| | C+7(L) | | | | |
| | C+8(H) | WHITE | 0-65535 | 0-100 | |
| | C+9(L) | | | | |
| | C+10 | FAN | 0-127 128-255 | 0-50 50-100 | Low speed Auto Fan |
| C+11 | CCT RGBW HSI Preset | 0-42 43-85 86-127 128-170 | 0-16 17-33 34-50 51-66 | | |

| All Light DMX Settings | | | | | |
|------------------------|---------|--|--|--|--|
| 16Bit | | | | | |
| MODE | CHANNEL | FUNCTION | VALUE | % | Notes |
| | | Filter Effect | 171-212 213-255 | 67-83 84-100 | |
| H S I | C+0(H) | DIMMER | 0-65535 | 0-100 | Channel set 1 - 501 |
| | C+1(L) | | | | |
| | C+2(H) | HUE | 0-65535 | 0-100 | |
| | C+3(L) | | | | |
| | C+4(H) | SATURATION | 0-65535 | 0-100 | |
| | C+5(L) | | | | |
| | C+6 | Reserved | | | |
| | C+7 | Reserved | | | |
| | C+8 | Reserved | | | |
| | C+9 | Reserved | | | |
| | C+10 | FAN | 0-127 128-255 | 0-50 50-100 | Low speed Auto Fan |
| | C+11 | CCT RGBW HSI Preset Filter Effect | 0-42 43-85 86-127 128-170 171-212 213-255 | 0-16 17-33 34-50 51-66 67-83 84-100 | |
| Preset | C+0(H) | DIMMER | 0-65535 | 0-100 | Channel set 1 - 501 |
| | C+1(L) | | | | |
| | C+2 | FACTORY / USER MANU | 0-5 6-130 131-255 | 0-1 2-51 51-100 | Preset Trigger Disabled User Preset Selected Factory Preset Selected |
| | C+3 | PRESET SELECT | 0-42 43-85 86-127 128-170 171-212 213-255 | 0-16 17-33 34-50 51-66 67-83 84-100 | Preset # 1 Preset # 2 Preset # 3 Preset # 4 Preset # 5 Preset # 6 |
| | C+4 | PRESET SELECT 2 | 0-31 32-63 64-95 96-127 128-159 160-191 192-223 224-255 | 0-12.5 12.5-25 25-37.5 37.5-50 50-62.5 62.5-75 75-87.5 87.5-100 | Preset Page # 1 (User, Factory Preset) Preset Page # 2 (User, Factory Preset) Preset Page # 3 (User, Factory Preset) Preset Page # 4 (User, Factory Preset) Preset Page # 5 (Only Factory Preset) Preset Page # 6 (Only Factory Preset) Preset Page # 7 (Only Factory Preset) Preset Page # 8 (Only Factory Preset) |
| | C+5 | Reserved | | | |
| | C+6 | Reserved | | | |
| | C+7 | Reserved | | | |
| | C+8 | Reserved | | | |
| | C+9 | Reserved | | | |
| | C+10 | FAN | 0-127 128-255 | 0-50 50-100 | Low speed Auto Fan |
| | C+11 | CCT RGBW HSI Preset Filter Effect | 0-42 43-85 86-127 128-170 171-212 213-255 | 0-16 17-33 34-50 51-66 67-83 84-100 | |
| Filter | C+0(H) | DIMMER | 0-65535 | 0-100 | Channel set 1 - 501 |
| | C+1(L) | | | | |
| | C+2 | Color Filter 1 / Color Filter 2LUX | 0-5 6-130 131-255 | 0-1 2-51 51-100 | Gel Trigger Disabled Color Filter 1 Filters Selected Color Filter 2lux Selected |
| | C+3 | FILTER SELECT | 0-28 29-56 57-84 | 0-10 11-21 22-32 | FILTER # 1 FILTER # 2 FILTER # 3 |

| All Light DMX Settings | | | | | |
|------------------------|---------|--|---|---|--|
| 16Bit | | | | | |
| MODE | CHANNEL | FUNCTION | VALUE | % | Notes |
| | | | 85-112 113-140 141-168 169-196 197-224 225-255 | 33-43 44-54 55-65 66-76 77-87 88-100 | FILTER # 4 FILTER # 5 FILTER # 6 FILTER # 7 FILTER # 8 FILTER # 9 |
| | C+4 | FILTER PAGE | 0-13 14-26 27-39 40-52 53-65 66-78 79-91 92-104 105-117 118-130 131-143 144-156 157-169 170-182 183-195 196-208 209-221 222-234 235-255 | 0-5 5-10 10-15 15-20 20-25 26-31 31-36 36-41 41-46 46-51 51-56 56-61 61-66 66-71 71-76 77-82 82-87 87-92 92-100 | Filter Page # 1 (Color Filter 1, Color Filter 2) Filter Page # 2 (Color Filter 1, Color Filter 2) Filter Page # 3 (Color Filter 1, Color Filter 2) Filter Page # 4 (Color Filter 1, Color Filter 2) Filter Page # 5 (Color Filter 1, Color Filter 2) Filter Page # 6 (Color Filter 1, Color Filter 2) Filter Page # 7 (Color Filter 1, Color Filter 2) Filter Page # 8 (Color Filter 1, Color Filter 2) Filter Page # 9 (Color Filter 1, Color Filter 2) Filter Page # 10 (Color Filter 1, Color Filter 2) Filter Page # 11 (Color Filter 1, Color Filter 2) Filter Page # 12 (Color Filter 1, Color Filter 2) Filter Page # 13 (Color Filter 1, Color Filter 2) Filter Page # 14 (Color Filter 1, Color Filter 2) Filter Page # 15 (Color Filter 1, Color Filter 2) Filter Page # 16 (Color Filter 1, Color Filter 2) Filter Page # 17 (Color Filter 1, Color Filter 2) Filter Page # 18 (Only Color Filter 2) Filter Page # 19 (Only Color Filter 2) |
| | C+5 | Reserved | | | |
| | C+6 | Reserved | | | |
| | C+7 | Reserved | | | |
| | C+8 | Reserved | | | |
| | C+9 | Reserved | | | |
| | C+10 | FAN | 0-127 128-255 | 0-50 50-100 | Low speed Auto Fan |
| | C+11 | CCT RGBW HSI Preset Filter Effect | 0-42 43-85 86-127 128-170 171-212 213-255 | 0-16 17-33 34-50 51-66 67-83 84-100 | |
| Effect | C+0(H) | DIMMER | 0-65535 | 0-100 | Channel set 1 - 501 |
| | C+1(L) | | | | |
| | C+2(H) | PERIOD | 0-65535 | 0-100 | Adjust the Period |
| | C+3(L) | | | | |
| | C+4 | 1~6 | 0-42 43-85 86-127 128-170 171-212 213-255 | 0-16 17-33 34-50 51-66 67-83 84-100 | <FLASH> 1.Camera, 2.Lightning, 3.ARC 4.TV, 5.High Beam, 6.Sun Light <COLOR> 1.Emergency, 2.Fire Works, 3.Party 4.Fire, 5.Light Pulsing, 6.Tunnle |
| | C+5 | FX Mode | 0-85 86-170 171-255 | 0-33 33-67 67-100 | Select Action Mode 1-3 |
| | C+6 | FLASH COLOR | 0-127 128-255 | 0-50 50-100 | Select Effect <FLASH>,<COLOR> |
| | C+7 | | | | |
| | C+8 | | | | |
| | C+9 | | | | |
| | C+10 | FAN | 0-127 128-255 | 0-50 50-100 | Low speed Auto Fan |
| | C+11 | CCT RGBW HSI Preset Filter Effect | 0-42 43-85 86-127 128-170 171-212 213-255 | 0-16 17-33 34-50 51-66 67-83 84-100 | |

04. Bluetooth Connection and App Operation ...

The Matrix Light All Light supports Bluetooth 4.0 mode and allows remote control of all lights through apps on Android or iOS-based wireless devices. For the Matrix Light All Light app, download and install the Matrixlight.apk file from the Matrix Light homepage, the Google Play store, or the Apple App Store, or search for the Matrix Light or All Light and install the app on your mobile device.

After the All Light app is installed, turn on the Bluetooth feature on the Android-based wireless device and run the All Light app. On the menu screen of the All Light app, press the Bluetooth button to search for Bluetooth equipment and select a device that starts with "All Light" to connect. The menu operation of the app is similar to the touchscreen menu of the All Light. Some functions may be provided in a different form from the touchscreen menu of the All Light, considering the transmission speed of the wireless connection and smooth operation.

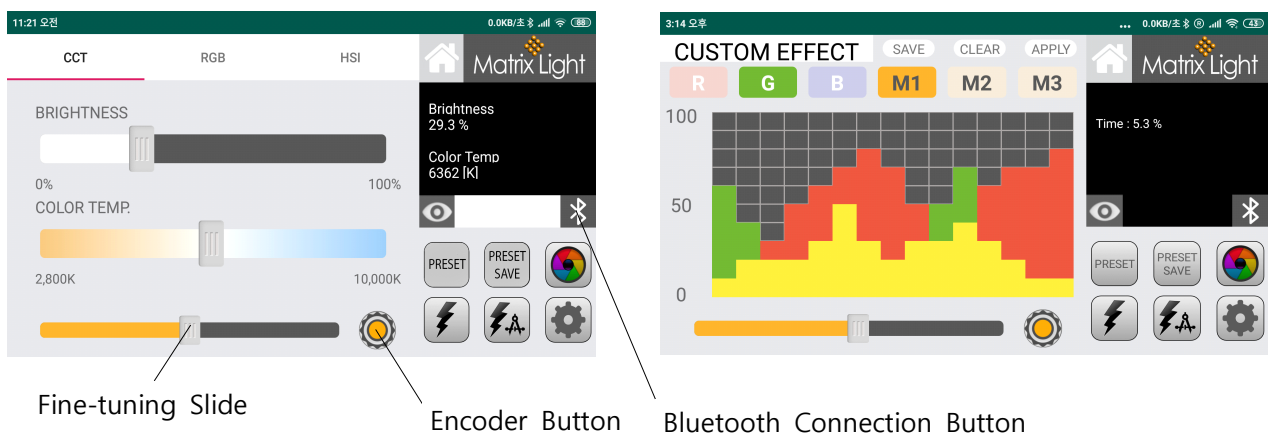

To connect to Bluetooth, press the Bluetooth connection button for the application. When Bluetooth is connected, the Bluetooth connection button changes color to blue.

When you connect the All Light with Bluetooth, the touchscreen features on the All Light body will be disabled until the Bluetooth connection is disabled. To re-enable the touchscreen feature of the All Light, you must turn off the Bluetooth connection.

The different menu configurations and functions of the application are similar to the menu configuration of the touch control panel in All Light.

For the Custom Effect, the horizontal axis in the grid area represents time and the vertical axis represents brightness.

To create a custom effect, touch the desired part of the tick display area to automatically fill the area below the touch. Also, if you select a different color and touch the desired part, the area below the touch is automatically filled, and the area overlaps with the previously selected color is displayed in a mixture of that color. To set the repeat time of the custom effect, you can set the repeat time between 0 and 10 seconds by moving the fine adjustment slide from side to side. Press the "SAVE" button at the top to save the created custom effect. To save the M1, M2, M3 buttons to the desired button, select one of the M1, M2, M3 buttons first, create a custom effect, and press the "SAVE" button to save the custom effect to the selected memory button. Press the "CLEAR" button to clear the stored custom effect or to clear the currently created custom effect.

The Bluetooth modules on the Matrix Light All Light operate at approximately 10M distances. However, the range of operation may be reduced in areas where there is a lot of shielding, indoors or in areas where there is a lot of electromagnetic waves. To increase the reach of the Bluetooth module, use the Bluetooth antenna located at the top of the rear of the All Light, and make sure to fold and store the antenna when you are not using the Bluetooth connection.

●●● Trouble Shooting

01. Check Point ●●●

If the light or battery doesn't work properly, check the following points first. If this does not solve the problem, please contact your local distributor or the Matrix Light service center.

| Symptom | Check Point |
|--|--|
| <p>Power is not working</p> | <ul style="list-style-type: none"> ■ Is there a power supply or battery connected to the light? Correctly connect the power supply or connect the charged battery to the light. ■ Is the battery less charged? Fully charge the battery, or replace with another charged battery. ■ Is it connected correctly? Make sure that the power terminals and lights are correctly connected with the power cable. See page 14 and 15. |
| <p>The lights don't work even though the power cable is connected to a charged battery or power supply.</p> | <ul style="list-style-type: none"> ■ Make sure that the switch on the power supply is turned on securely. ■ Make sure the inside temperature of the light is not too high. Turn off the light and let it cool for a while. |
| <p>The power goes off automatically.</p> | <ul style="list-style-type: none"> ■ Make sure there is not enough battery charge. If the battery is running low, charge it again. ■ Make sure the inside temperature of the light is not too high. Turn off the light and let it cool for a while. |
| <p>The noise from the cooling fans is too loud.</p> | <ul style="list-style-type: none"> ■ Make sure that the front and rear of the light are not blocked. ■ Check for dust or foreign substances outside the light. ■ If there is a lot of dust outside the light, blow the dust lightly with a blower, then wipe it lightly with a soft, clean cloth. ■ Make sure that only the high temperature or light is used in a confined and confined space for a long time. ■ To protect your device, avoid putting it in a hot and humid place or in a separate sealed case. |
| <p>The battery is running out fast.</p> | <ul style="list-style-type: none"> ■ This may occur if the ambient temperature is too low. It's not a fault. ■ The battery is not sufficiently charged. Recharge the battery. If the problem persists, replace with a new battery. ■ Is the battery out of life? Replace with a new battery. |

••• Other information

01. Warranty •••

- Free warranty period for products is one year after purchase.
- Faults caused by customer negligence or natural disasters are serviced for free even during the service period.
- To receive free service, please send the receipt with the purchase date to the head office or agency or visit the service center.

02. Storage method •••

- Store in a well-ventilated, dry place.
- Do not place near naphthalene or magnetic-producing instruments.
- Do not leave it in high temperatures (in the car in summer, near the stove, etc.).
- Remove the power supply, battery, and light after filming.
- If you move to a place with a high temperature difference, you may see drops of water inside the light, power supply or battery. If possible, put it in a bag or plastic bag and use it after you become familiar with the temperature around it.

03. Product specifications •••

| Lamp Head | |
|-----------------------------|---|
| Optical System | Soft Diffusion Panel |
| Light Aperture | ML-AL1: 310 x 166 mm / 12.2 x 6.5" (All Light 1) ML-AL2: 310 x 310 mm / 12.2 x 12.2" (All Light 2) ML-AL4: 610 x 310 mm / 24.4 x 12.2" (All Light 4) |
| Beam Angle | 115° (Half Peak Angle) |
| Weight | ML-AL1: 6.5kg/14.3lbs (All Light 1) ML-AL2: 8.9kg/19.6lbs (All Light 2) ML-AL4: 16kg/35.3lbs (All Light 4) |
| Handling | Aluminum Yoke, High Strength Tilt Lock, Pole Operation Option (Pan & Tilt) |
| Mounting | 16 mm / 28 mm Combo Pin (Baby 5/8" / Junior 1-1/8" Combo Pin) |
| Tilt Angle | +/- 90° |
| Lamphead Voltage Input | 48 V DC |
| Power Consumption | 48V DC / 2.6A / 110 W Nominal, 120 W Maximum (All Light 1) 48V DC / 5.2A / 220 W Nominal, 290 W Maximum (All Light 2) 48V DC / 10.4A / 450 W Nominal, 580 W Maximum (All Light 4) |
| Lamphead Power Connection | Male 3-Pin XLR - 15 Amp (Pin 1: Negative / Pin 2: Positive) |
| Battery Connector | Male 3-Pin XLR - 15 Amp (Pin 1: Negative / Pin 2: Positive) |
| Battery DC Voltage Range | 48 V DC |
| Battery Mode Light Output | 100 % of total output |
| White Light | 2,800 K to 10,000 K continuously variable correlated color temperature |
| Colored Light | Full RGB+WW+PW color gamut with Hue and Saturation control |
| Color Temperature Tolerance | +/- 100 K (nominal), +/- 1/8 Green-Magenta (nominal) |
| Color Rendition | CRI Average > 95 TLCI Average > 91 |
| Green-Magenta Adjustment | continuously adjustable (Full Minusgreen to Full Plusgreen) |
| Dimming | 0 to 100 % continuous |
| Control | On-Board Controller, 5-Pin DMX In and Through, RJ45 LAN network connectivity, USB-A |
| Bluetooth Connectivity | DMX Setup, Hour Counter and Standard Control commands |

Matrix Light All Light

Lamp Head

| | |
|---|---|
| Software Interface | RJ45: DMX In and Through USB-A: Software Upgrade via flash drive |
| Housing Color | Orange / Silver, Black, White |
| Ambient Temperature Operation | -20 to +45° C (-4 to +113° F) |
| Protection Class / IP Rating | III / IP20 |
| Estimated LED Lifetime (L70) | 50,000 hours |
| Estimated Color Shift Over Lifetime (CCT) | +/- 5 % |

Power Supply Unit

| | |
|---------------------------|---|
| Power Supply Input Range | 110 to 240 V ~, 50/60 Hz |
| Power Supply Output Range | 48 V DC |
| Power Input Connection | PowerCON TRUE1 (Bare Ends / Schuko / Edison cables available) |
| Power Output Connection | Female 3-Pin XLR - 10 Amp (Pin 1: Negative / Pin 2: Positive) PowerCON TRUE1 (mains power through) |
| Weight | ML-APS1: 2.5Kg/5.5lbs ML-APS2: 2.9Kg/6.4lbs ML-APS4: 4.9Kg/10.8lbs |
| Dimensions | 348 x 124 x 70 mm / 13.7 x 5.4 x 2.8" (ML-APS1,2) 390 x 176 x 76 mm / 15.3 x 6.9 x 3.0" (ML-APS4) |
| Control | On-Board On/Off Switch |
| Mounting | All Light ML-AT2 Quick Release Clamp Adapter / ML-QR1 Rail Mount Adapter |

Photometric Data

| | 3 m / 9.8 ft | | 5 m / 16.4 ft | | 7 m / 23 ft | | 9 m / 29.5 ft | |
|-------------------------------------|-----------------|-----------------|-----------------|-----------------|---------------|---------------|---------------|---------------|
| All Light 1 | 3,200 K | 5,600 K | 3,200 K | 5,600 K | 3,200 K | 5,600 K | 3,200 K | 5,600 K |
| All Light 1 with Standard Diffusion | 414 lx 38 fc | 406 lx 38 fc | 149 lx 14 fc | 146 lx 14 fc | 76 lx 7 fc | 74 lx 7 fc | 46 lx 4 fc | 45 lx 4 fc |
| All Light 1 with Lite Diffusion | 448 lx 42 fc | 437 lx 41 fc | 161 lx 15 fc | 157 lx 15 fc | 82 lx 7 fc | 80 lx 7 fc | 50 lx 5 fc | 49 lx 5 fc |
| All Light 1 with Heavy Diffusion | 343 lx 32 fc | 333 lx 31 fc | 124 lx 11 fc | 120 lx 11 fc | 63 lx 6 fc | 61 lx 5 fc | 38 lx 3 fc | 37 lx 3 fc |

| | 3 m / 9.8 ft | | 5 m / 16.4 ft | | 7 m / 23 ft | | 9 m / 29.5 ft | |
|-------------------------------------|-----------------|-----------------|-----------------|-----------------|-----------------|-----------------|----------------|---------------|
| All Light 2 | 3,200 K | 5,600 K | 3,200 K | 5,600 K | 3,200 K | 5,600 K | 3,200 K | 5,600 K |
| All Light 2 with Standard Diffusion | 829 lx 77 fc | 811 lx 76 fc | 298 lx 28 fc | 292 lx 27 fc | 153 lx 14 fc | 149 lx 14 fc | 92 lx 8 fc | 90 lx 8 fc |
| All Light 2 with Lite Diffusion | 895 lx 84 fc | 873 lx 81 fc | 323 lx 30 fc | 315 lx 30 fc | 165 lx 15 fc | 161 lx 15 fc | 100 lx 9 fc | 97 lx 9 fc |
| All Light 2 with Heavy Diffusion | 686 lx 63 fc | 667 lx 62 fc | 247 lx 23 fc | 240 lx 23 fc | 126 lx 12 fc | 123 lx 11 fc | 76 lx 7 fc | 74 lx 7 fc |

| | 3 m / 9.8 ft | | 5 m / 16.4 ft | | 7 m / 23 ft | | 9 m / 29.5 ft | |
|-------------------------------------|-------------------|-------------------|-----------------|-----------------|-----------------|-----------------|-----------------|-----------------|
| All Light 4 | 3,200 K | 5,600 K | 3,200 K | 5,600 K | 3,200 K | 5,600 K | 3,200 K | 5,600 K |
| All Light 4 with Standard Diffusion | 1658 lx 154 fc | 1623 lx 151 fc | 597 lx 57 fc | 583 lx 54 fc | 305 lx 27 fc | 297 lx 27 fc | 184 lx 16 fc | 181 lx 16 fc |
| All Light 4 with Lite Diffusion | 1790 lx 167 fc | 1747 lx 162 fc | 645 lx 59 fc | 629 lx 59 fc | 329 lx 30 fc | 321 lx 30 fc | 200 lx 19 fc | 194 lx 19 fc |
| All Light 4 with Heavy Diffusion | 1372 lx 127 fc | 1334 lx 124 fc | 494 lx 46 fc | 481 lx 46 fc | 251 lx 24 fc | 246 lx 22 fc | 151 lx 14 fc | 149 lx 14 fc |

Product Dimension

All Light 1

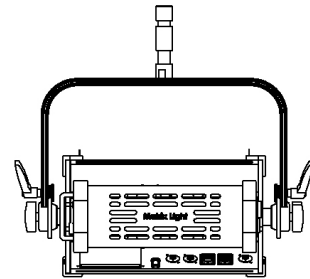
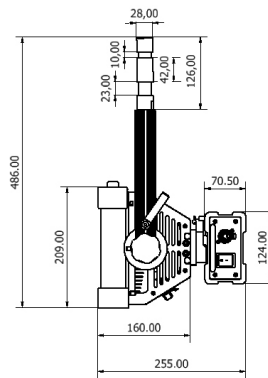
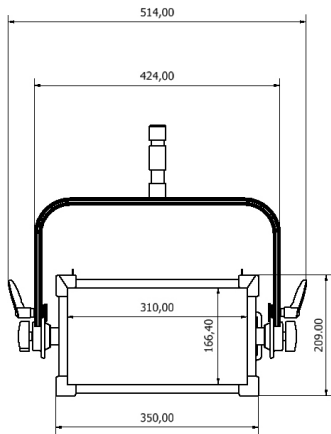
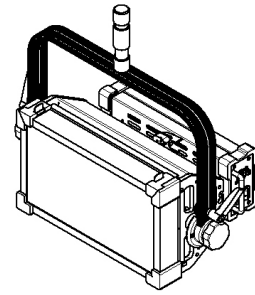
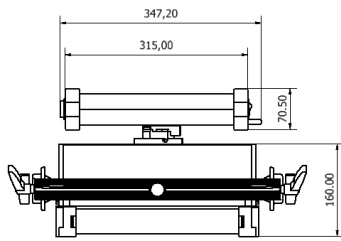

All Light 2

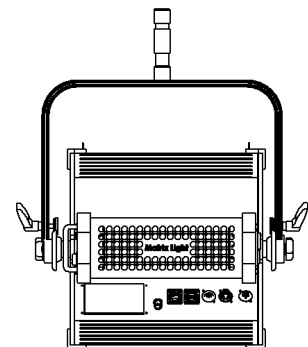
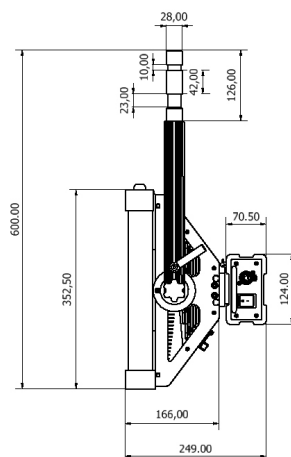
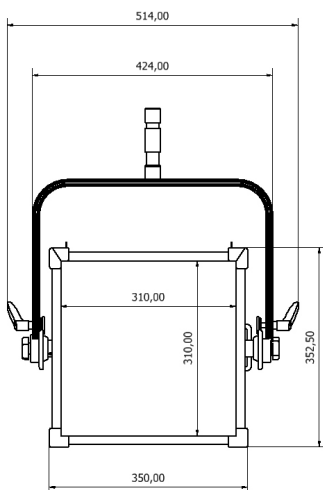
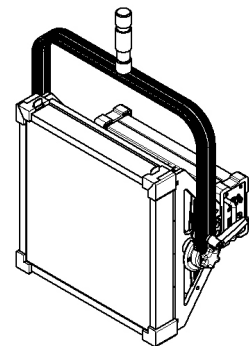
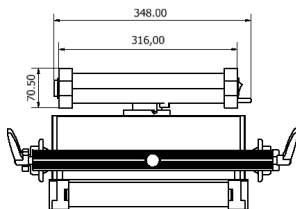

All Light 4

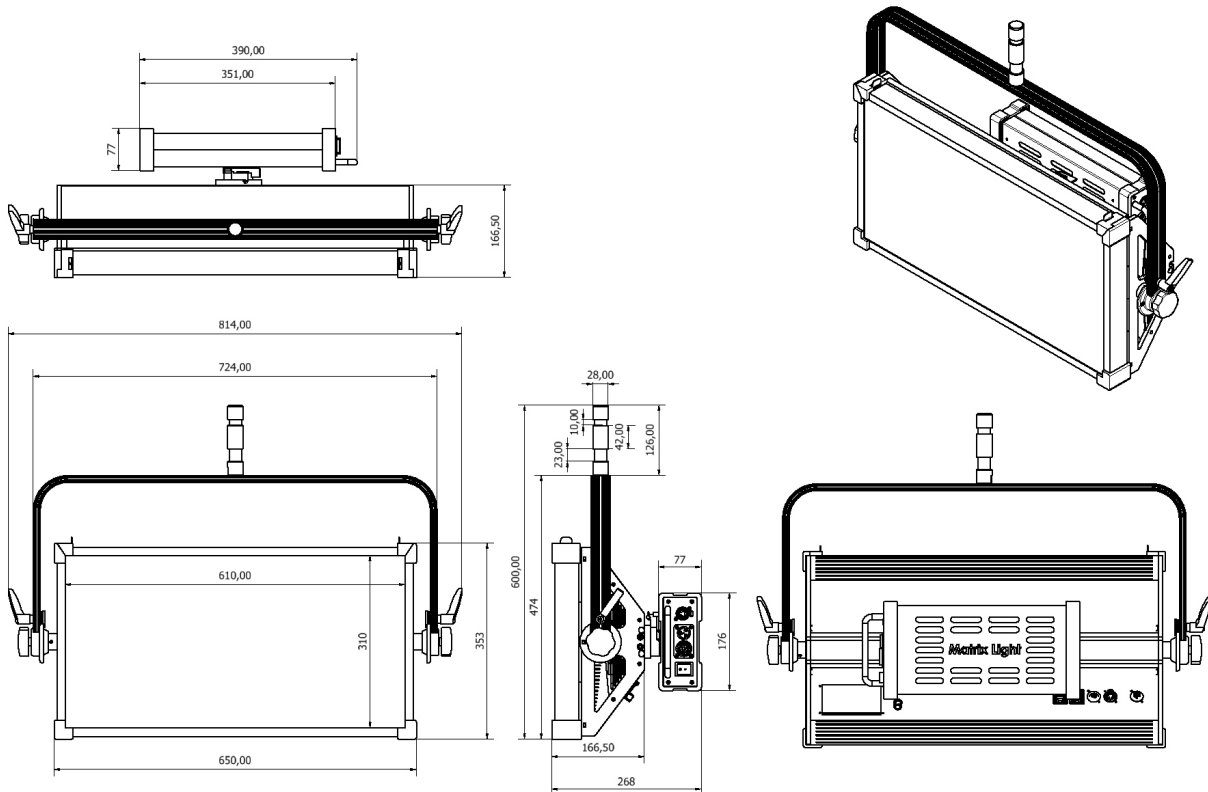

04. Product A/S information ...

- Visit the Matrix Light website at www.matrixlight.com or call 02-782-2888 for A/S related inquiries in Korea.
- For overseas A/S-related inquiries, visit the Matrix Light website at www.matrixlight.com or email csmatrixlight@gmail.com
- For guidance on overseas A/S-related agencies and service centers, visit the Matrix Light website at www.matrixlight.com or contact us at csmatrixlight@gmail.com
- For product A/S related inquiries, please tell us the serial number of the product, the date of purchase of the product, the place of purchase of the product, and the details of the defect, for faster service.

Thank you